

Exam Questions 220-1101

CompTIA A+ Certification Exam: Core 1

<https://www.2passeasy.com/dumps/220-1101/>



NEW QUESTION 1

A help desk technician thinks a desktop PC has failed due to a defective power supply. Which of the following steps should the technician take NEXT?

- A. Inquire about environmental or infrastructure changes.
- B. Conduct external or internal research based on symptoms.
- C. Establish a plan of action to resolve the problem and implement the solution.
- D. Document the findings, actions, and outcomes.

Answer: B

Explanation:

<https://spryzensecurity.medium.com/what-is-troubleshooting-methodology-40cec6b6494>

NEW QUESTION 2

A technician is configuring a workstation to be used as a VM host. After installing the necessary software, the technician is unable to create any VMs. Which of the following actions should be performed?

- A. Disable the BIOS password.
- B. Enable TPM.
- C. Enable multithreading.
- D. Enable Fast Startup.

Answer: B

Explanation:

If you want to install Windows 11 on a virtual machine using Hyper-V, you will have to use a “Generation 2” VM and enable the “trusted platform module” (TPM) and Secure Boot options. Otherwise, the OS won’t install.

Starting with Windows 11, Microsoft is changing the system requirement and making TPM 2.0 and Secure Boot a prerequisite to perform an in-place upgrade or clean install the new version on any device. This is in addition to the new 4GB of RAM and at least 64GB of storage.

quoted from here:

<https://pureinfotech.com/enable-tpm-secure-boot-hyperv-install-windows-11/> Furthermore, Multithreading is not a requirement for hyper-v hosting.

NEW QUESTION 3

A user's computer is not receiving a network connection. The technician confirms that the connection seems to be down and looks for the user's port on the patch panel. The port and patch panel are not labeled. Which of the following network tools should the technician use to identify the port?

- A. Network tap
- B. Punchdown tool
- C. Toner probe
- D. Crimper

Answer: C

Explanation:

Toner Probe Many cable testers also incorporate the function of a toner probe, which is used to identify a cable from within a bundle. This may be necessary when the cables have not been labeled properly. The tone generator is connected to the cable using an RJ45 jack and applies a continuous audio signal on the cable. The probe is used to detect the signal and follow the cable over ceilings and through ducts or identify it from within the rest of the bundle.

NEW QUESTION 4

An online retailer would like to add capacity to support increased sales. Additional servers have been installed. Which of the following should be used to ensure each new server is being properly utilized?

- A. Virtualization
- B. Clustering
- C. Load balancer
- D. Round-robin DNS

Answer: C

Explanation:

<https://www.resonatenetworks.com/2020/04/29/clustering-vs-load-balancing-whats-the-difference/>

NEW QUESTION 5

A company has a dot matrix printer that uses carbon paper. The company reports that the first page is printing too light, although the following pages are still legible. Which of the following MOST likely needs to be fixed?

- A. The print drum is worn and loose causing the printing to be light in places
- B. The ribbon is low on ink or missing and must be replaced to get proper output
- C. The heating element has failed, and a new one needs to be installed for proper transfer
- D. The wrong type of filament is loaded, preventing it from sticking correctly
- E. The fuser assembly is not calibrated properly, causing it to impact the paper too hard

Answer: B

Explanation:

Dot Matrix printers do not use heat, they use a pin striking an inked ribbon (for the first copy, the subsequent copies are handled by the carbon paper)

NEW QUESTION 6

A technician needs to improve a workstation's overall response time for frequently used applications and data without removing the current hard drive. Which of the following storage devices should the technician install to BEST accomplish the objective?

- A. M.2
- B. SAS
- C. HDD
- D. SCSI

Answer: A

NEW QUESTION 7

An insurance company wants to implement cloud computing and would like a cloud solution in which the infrastructure is shared with businesses in the same industry. Which of the following cloud models BEST addresses the company's need?

- A. Community
- B. Private
- C. Public
- D. Hybrid

Answer: D

Explanation:

In a hybrid cloud model, the infrastructure is shared between public cloud services and an on-premise private cloud. This means that the insurance company can benefit from the scalability and cost-effectiveness of public cloud services, while also having the control and security of a private cloud. This allows the company to access resources that are specialized to their industry, while also ensuring that their data and infrastructure are kept secure.

NEW QUESTION 8

Recently, an organization received a number of spam emails that passed through the spam gateway. The emails contained generally the same information, but the sending domains were different. Which of the following solutions would BEST help mitigate the issue?

- A. Updating the keyword filtering
- B. Editing the sender policy framework
- C. Contacting the gateway vendor
- D. Verifying DMARC is enabled

Answer: D

Explanation:

DMARC (Domain-based Message Authentication, Reporting and Conformance) is an email authentication protocol. It is designed to give email domain owners the ability to protect their domain from unauthorized use, commonly known as email spoofing.

NEW QUESTION 9

An administrator is configuring a corporate-owned smartphone for a new manager. The company requires the ability to wipe the phone's data remotely in the event of loss or theft and the capability to approve applications installed on the phone. Which of the following tools would BEST meet this need?

- A. Tethering to a corporate-owned laptop
- B. WPA2-Enterprise wireless
- C. Corporate enterprise email
- D. Mobile device management

Answer: D

NEW QUESTION 10

Which of the following connectors can be plugged into a Thunderbolt 3 port on a laptop?

- A. miniUSB
- B. microUS3
- C. USB-A
- D. USB-C

Answer: C

Explanation:

Thunderbolt 3 is a USB-C port, so any device with a USB-C connector can be plugged into it. MiniUSB, microUSB and USB-A are not compatible with Thunderbolt 3.

NEW QUESTION 10

An organization has some computers running macOS and some computers running Windows. The computers running macOS also need to run a piece of software that is only available on Windows. Which of the following BEST describes the solution for running Windows software on a computer running macOS?

- A. Operating system spoofing
- B. Remote software provisioning
- C. Indirect software implementation
- D. Cross-platform virtualization

Answer: D

NEW QUESTION 12

A technician is replacing a computer with a connected point-of-sale system using a 9-pin serial adapter. The new computer does not have a 9-pin serial port. Which of the following ports can an adapter be installed on in order to connect to the point-of-sale system?

- A. HDMI
- B. Bluetooth
- C. USB
- D. Lightning

Answer: A

NEW QUESTION 14

A user, who is attempting to give a presentation via a projector in a conference room, reports the projector has video but no audio. Which of the following will MOST likely resolve the issue?

- A. Changing the input on the projector to VGA
- B. Changing the output on the PC to DVI
- C. Modifying the projector's refresh rate
- D. Utilizing an HDMI connection

Answer: D

NEW QUESTION 18

A technician installed a Cat 5 UTP cable approximately 275ft (84m) from a network switch in an office to a workstation located on a factory floor. The technician sees both a flashing green LED and a flashing orange LED on the workstation's NIC. Which of the following should the technician do FIRST?

- A. Check for loose connections, pinched bends, and physical damage.
- B. Install a powered hub as close as possible to the halfway point in the Cat 5 UTP cable run.
- C. Replace the entire run of Cat 5 UTP cable with Cat 5 STP cable.
- D. Upgrade the entire cable run to multimode fiber.

Answer: C

NEW QUESTION 19

A technician is monitoring all outbound traffic in a SOHO. Which of the following is the MOST cost-effective solution to monitor the traffic?

- A. Spectrum analyzer
- B. Network tap
- C. Lookback plug
- D. Toner probe

Answer: B

NEW QUESTION 20

A user brings an older laptop to the help desk and reports issues with the keyboard. Upon inspection, the technician does not see any external damage but notices that many keystrokes do not register in a word processor. The laptop works fine when the technician tests it with an external keyboard. Which of the following actions would MOST likely resolve the issue?

- A. Disable the sticky keys feature.
- B. Clean the keyboard.
- C. Reset the BIOS settings to default.
- D. Charge the laptop.

Answer: C

NEW QUESTION 23

A software developer used client-side virtualization on a server to configure a web application. Although the application is working locally on the software developer's PC, other users on the LAN are not able to access the application. Which of the following would allow other users to access the application?

- A. Bridge networking
- B. Application virtualization
- C. Virtual desktop
- D. Site-to-site VPN

Answer: A

Explanation:

Client-side virtualization is used to run an application or process on a separate virtual machine, isolated from the main operating system. To allow other users on the LAN to access the application, the software developer should configure a bridge networking connection between the virtual machine and the LAN. This will allow the virtual machine to communicate with other computers on the network. Application virtualization, virtual desktop, and site-to-site VPN are not necessary steps for allowing other users to access the application.

NEW QUESTION 26

While implementing a non-carrier-grade wireless backhaul, a technician notices the current channel selection is externally polluted with various RF signals. Upon performing a spectral analysis, the technician discovers a channel containing almost no RF pollution. Unfortunately, the technician is unable to select that channel. Which of the following is the MOST likely reason for this issue?

- A. The channel is reserved for licensed band use.
- B. The channel selection is defective, contact the manufacturer.
- C. The channel must be unblocked by the vendor.
- D. The device requires a firmware update to unlock the channel.

Answer: A

Explanation:

The 2. band is subdivided into up to 14 channels, spaced at 5 MHz intervals from 2412 MHz up to 2484 MHz. Wi-Fi requires bandwidth of approximately 20 MHz, not 5 MHz. Consequently, a site designer needs to choose the channels that do not overlap. On a WLAN where only the first 11 channels are available, channels 1, 6, and 11 can be selected as non-overlapping. Note: In the Americas, regulations permit the use of channels 1-11 only, while in Europe, channels 1-13 are permitted. In Japan, all 14 channels are permitted.

NEW QUESTION 31

An engineer is experiencing unexpected reboots on a graphics workstation when rendering complex 3-D models. The workstation is configured with a 115V power supply that is rated at 200W and connected to a UPS. The central processing unit contains 16 hyperthreaded cores, and a discrete graphics solution utilizing an 8-pin power connector is installed in a PCI Express x16 slot. Which of the following indicates where the technician should begin troubleshooting?

- A. The UPS, as 115V is insufficient for the configuration and should be increased to 220V
- B. The power supply, as 200W is insufficient when the GPU is heavily tasked
- C. The graphics card, as it is the component that triggers the unexpected reboots
- D. The motherboard, as only standard PCI slots should be used for high-end graphics cards, not PCI Express slots

Answer: B

NEW QUESTION 33

A technician is receiving reports that the entire office sporadically loses network connectivity throughout the day. The technician determines the root cause to be EMI. Which of the following cable mediums would be the MOST cost effective without sacrificing system performance?

- A. Coaxial
- B. Shielded Cat 6
- C. Plenum Cat 5e
- D. Multimode fiber

Answer: B

NEW QUESTION 35

A user submits a help desk ticket regarding a smartphone that will no longer accept its charging cable. The assigned technician notices the phone does not have a protective case, and the user constantly transport the phone in a pocket. The technician attempts to use a secondary charger, but the cable falls out of the phone. Which of the following is the MOST likely cause of the issue?

- A. The phone requires a firmware update to address charging issues.
- B. The charge port contains foreign objects, such as lint.
- C. The phone's battery has swelled, preventing the utilization of the charge port.
- D. The phone has experienced water damage, thus the battery is not charring.

Answer: B

NEW QUESTION 40

A technician installed a new router at a small office. After the Installation, the technician notices that all devices have a 169.254.x.x IP address. Printers and fileshares are still working, but PCs cannot access the Internet. Which of the following should the technician configure on the router to enable devices to connect to the internet?

- A. APIPA
- B. DNS
- C. DHCP
- D. SMB

Answer: B

NEW QUESTION 42

A technician was called in to look at a user's PC. The user reported the PC was very sluggish. The HDD light on the PC was constantly on without blinking. The PC itself was slow receiving input and took a very long time to load the OS. The technician also noticed updates had failed. Which of the following is MOST likely the cause of these issues?

- A. The hard disk drivers have been corrupted
- B. The HDD cables need reseating.
- C. A RAID disk failed.
- D. The HDD has no free space.

Answer: A

NEW QUESTION 43

Which of the following wireless technologies has the MOST range and wireless throughput?

- A. 802.11ac
- B. 802.11ax
- C. 802.11b/g/n
- D. 802.11g

Answer: B

NEW QUESTION 48

A technician is troubleshooting a computer that is not completing POST and gets stuck at the manufacturer logo screen. All internal, removable parts have been disconnected and only the minimum parts necessary to POST were reconnected. However, the symptoms remain the same. Which of the following should the technician try NEXT?

- A. Test the RAM in different slots, one at a time.
- B. Remove and test the power supply.
- C. Replace the motherboard.
- D. Change the CMOS battery.

Answer: A

Explanation:

CMOS is for date and time and should not stop a host from booting. If working on a host with ECC memory you would test the ram in a different slot or a different stick all together. If that did not work, I would swap in the other CPU to check if that is the issue. The ECC part isn't important other than that's what I'm used to working on at AWS and that is the only way you would be able to swap the CPUs easily.

NEW QUESTION 50

An organization is looking to upgrade the processing ability for its computers. Most users report that whenever multiple applications are being utilized, the system's response time slows down drastically. When only one application is open, the response time is acceptable. Which of the following should be upgraded FIRST?

- A. SSD
- B. CPU
- C. HDD
- D. RAM

Answer: D

Explanation:

'Upgrading to a faster CPU will improve your PC's single-application performance, making games run more smoothly, for example. Adding more RAM to your PC increases its multitasking capacity, but won't necessarily improve its single-application performance'

NEW QUESTION 52

An IT manager discovered that hundreds of pages of printed materials are being recycled each day because the materials are left on the printer tray instead of being picked up by users. Which of the following would BEST prevent this waste?

- A. Send friendly reminders to not print unnecessarily.
- B. Enable duplex printing to reduce paper utilization.
- C. Bill each department for the excess material cost.
- D. Require a code or badge before releasing a print job.

Answer: B

NEW QUESTION 57

An office manager reports that a printer is experiencing performance issues. Printouts are smudging when they are handled, and, recently, whenever the manager tries to print oversized documents, the paper jams before anything is printed on it.



- A. Mastered
- B. Not Mastered

Answer: A

Explanation:

A picture containing text, electronics, printer Description automatically generated

NEW QUESTION 58

A technician installs a new printer for a workstation and tries to print a test page, but the page does not print. The technician looks at the print queue and notices that the printer is called 'Generic Printer.' Which of the following BEST describes what the technician should do to fix this issue?

- A. Connect the printer with a USB cable rather than over the network.
- B. Install the appropriate printer drivers for the OS.
- C. Install the correct toner in the printer.
- D. Set the printer trays to allow duplex printing

Answer: B

NEW QUESTION 62

A user failed to gain access to a building's entrance after security measures at the entrance were upgraded last week. The company implemented the 13.56MHz frequency short band, and users can now utilize their mobile devices to authenticate. Which of the following has to be enabled for the mobile device to authenticate?

- A. Bluetooth
- B. Biometrics
- C. NFC
- D. PIN

Answer: C

NEW QUESTION 65

A client wants to connect an external keyboard to an Android tablet. Which of the following connection types are appropriate for this task? (Select TWO).

- A. DVI
- B. Infrared
- C. Lightning
- D. USB-C
- E. PS/2
- F. Bluetooth

Answer: AD

NEW QUESTION 68

A technical lead wants to migrate all common business applications, including email and fileshares, to the cloud. Which of the following cloud concepts should be used?

- A. MaaS
- B. PaaS
- C. SaaS
- D. IaaS

Answer: C

NEW QUESTION 70

A technician is preparing to set up a gaming computer with the following components:

- Discrete, high-end graphics card
- Video capture card
- High-end processor
- Multiple hard drives
- USB 3.0 hub
- Sound card

Which of the following options is the MOST important for the technician to consider before building the gaming computer?

- A. Redundant power supply
- B. Modular power supply
- C. 20-pin v
- D. 24-pin power adapter
- E. Power supply wattage rating

Answer: D

NEW QUESTION 71

A user is unable to plug a USB 3.0 device into a USB port. Upon inspection, a technician notices the USB 3.0 port appears to be slightly smaller than the other connections. Which of the following is the MOST likely cause?

- A. A foreign object is stuck inside the port
- B. The cable connection utilized the wrong orientation.
- C. The USB cable is physically damaged.
- D. The USB port belongs to a different form factor.

Answer: D

Explanation:

USB 3.0 ports are slightly smaller than other USB connections, so if the port appears to be the wrong size, it is likely that the port belongs to a different form factor. This can be caused by a number of factors, such as the device being too old to support USB 3.0, or the device not having a USB 3.0 port in the first place.

NEW QUESTION 74

A salesperson is using a weather application on a mobile device. The application appears to be draining the device's battery very quickly. Which of the following is the BEST action for the salesperson to take in order to view weather forecasts while traveling?

- A. Enable the GPS service to ensure accurate location detection.
- B. Update the PRL when getting to a new location.
- C. Configure less location checks using cellular location services.
- D. Use the offices' Wi-Fi IP addresses as the geolocation mechanism.

Answer: C

Explanation:

The best action for the salesperson to take in order to view weather forecasts while traveling and minimize the battery drain on their mobile device is to configure fewer location checks using cellular location services. This can be done by adjusting the settings for the weather application to limit how often it checks for updates and uses location services. This will help to conserve the battery on the device and keep the application from consuming too much power.

NEW QUESTION 77

Which of the following would MOST likely be used to connect one or more devices to the internet in a SOHO?

- A. Hub
- B. Ethernet gateway
- C. Wireless access point
- D. Router

Answer: C

NEW QUESTION 78

A technician is setting up a projector (or a videoconferencing system). When the user attempts to connect a laptop to the system, the system displays the following error message.

No source found

The user tries multiple cables and inputs on the projector. Which of the following should the user try NEXT?

- A. Check the bulb on the projector and replace it with a new one.
- B. Check the display settings on the computer and set them to extend/duplicate.
- C. Replace the projector with another known-good one and try again.
- D. Replace the video card on the machine that is plugged in to the projector, as it has gone bad.

Answer: B

NEW QUESTION 82

A user on the marketing team uses various multimedia applications that consume a lot of memory. The user needs to install more RAM to run these applications effectively. When the user opens the computer case, the user sees four slots in two sets of colors. Which of the following memory types is MOST likely required?

- A. Dual-channel
- B. Triple-channel
- C. Single-channel
- D. Quad-channel
- E. Error correction code RAM

Answer: A

NEW QUESTION 84

A technician has set up a new conference room with a TV and a video soundbar. The technician wants to test the system with a conference call. During the test, the TV speaker produces sound, but the soundbar does not. Which of the following is the MOST likely cause of the issue?

- A. The volume on the TV needs to be turned up.
- B. The conference call needs to be unmuted for audio.
- C. An incorrect HDMI cable is being used.
- D. The TV's HDMI-ARC port is not being use

Answer: D

Explanation:

HDMI-ARC (Audio Return Channel) is an HDMI connection that allows audio to be sent from the TV to an external sound system, such as a soundbar. If the TV's HDMI-ARC port is not being used, then the soundbar will not receive any audio from the TV and thus will not produce any sound. To resolve the issue, the technician should ensure that the TV's HDMI-ARC port is being used to connect the TV to the soundbar.

NEW QUESTION 86

A technician receives several error alerts on a server after an unexpected reboot. A message states that one or more disks are in a degraded state. When the technician advances to the next error message, it indicates the OS is missing. Which of the following are the MOST likely causes of these errors? (Choose two.)

- A. Missing drives in the OS
- B. RAID failure
- C. Bootable device not found
- D. Data loss
- E. Controller failure
- F. CMOS corruption
- G. TPM malfunction

Answer: BC

NEW QUESTION 91

Which of the following 802.11 standards supports both 5GHz and 2.4GHz channel frequencies?

- A. 802.11a
- B. 802.11c
- C. 802.11b
- D. 802.11g

Answer: B

NEW QUESTION 92

A technician recently received a written warning for causing a system-wide outage. The outage was a result of an unscheduled patch being manually pushed during production hours. Which of the following could have MOST likely prevented the technician from receiving the warning?

- A. Following corporate procedures
- B. Testing before deployment
- C. Documenting the findings
- D. Establishing a plan of action

Answer: A

Explanation:

Following corporate procedures would have been the most likely factor that could have prevented the technician from receiving the written warning. Following established procedures, such as change management, helps ensure that changes made to the production environment are thoroughly tested, approved, and implemented in a controlled and safe manner, reducing the risk of system-wide outages and other unintended consequences.

NEW QUESTION 95

The IT department issued a corporate smartphone to a user, but the user returned the device stating it had connectivity Issues. The user claimed the device functioned on WI-FI but all connectivity to cloud services was lost as soon as the device was taken off site. Which of the following issues was MOST likely affecting the device?

- A. MDM was never properly set up on the device.
- B. S/MIME certificates were corrupted and needed to be reloaded.
- C. Bluetooth on the device was disabled by mistake.
- D. The device never had a proper SIM card installed.

Answer: D

Explanation:

A SIM card is needed for the device to use cellular network services, so without it, the device will be unable to connect to the cloud services when taken off site. MDM (Mobile Device Management) can be used to manage settings and access on a device, but it is not necessary for the device to be able to use cloud services. S/MIME (Secure/Multipurpose Internet Mail Extensions) certificates are used to encrypt and digitally sign emails, and are not related to device connectivity. Bluetooth can be used to connect devices together, but it is not necessary for the device to be able to use cloud services.

NEW QUESTION 96

A small ISP has hired a new technician Joe, the new technician, is being trained to configure customers* home networks The trailing instructor gives me technician a starter kit with cables, cable ends, and other network equipment and asks mm to build a working network.

The computer should be connected to have internet connectivity and the phone should be connected to have a dial tone.

INSTRUCTIONS

Use the appropriate cables. cable ends, tools and equipment to configure the network ana connect an components accordingly

There are 3 steps and the simulation starts on step 1.

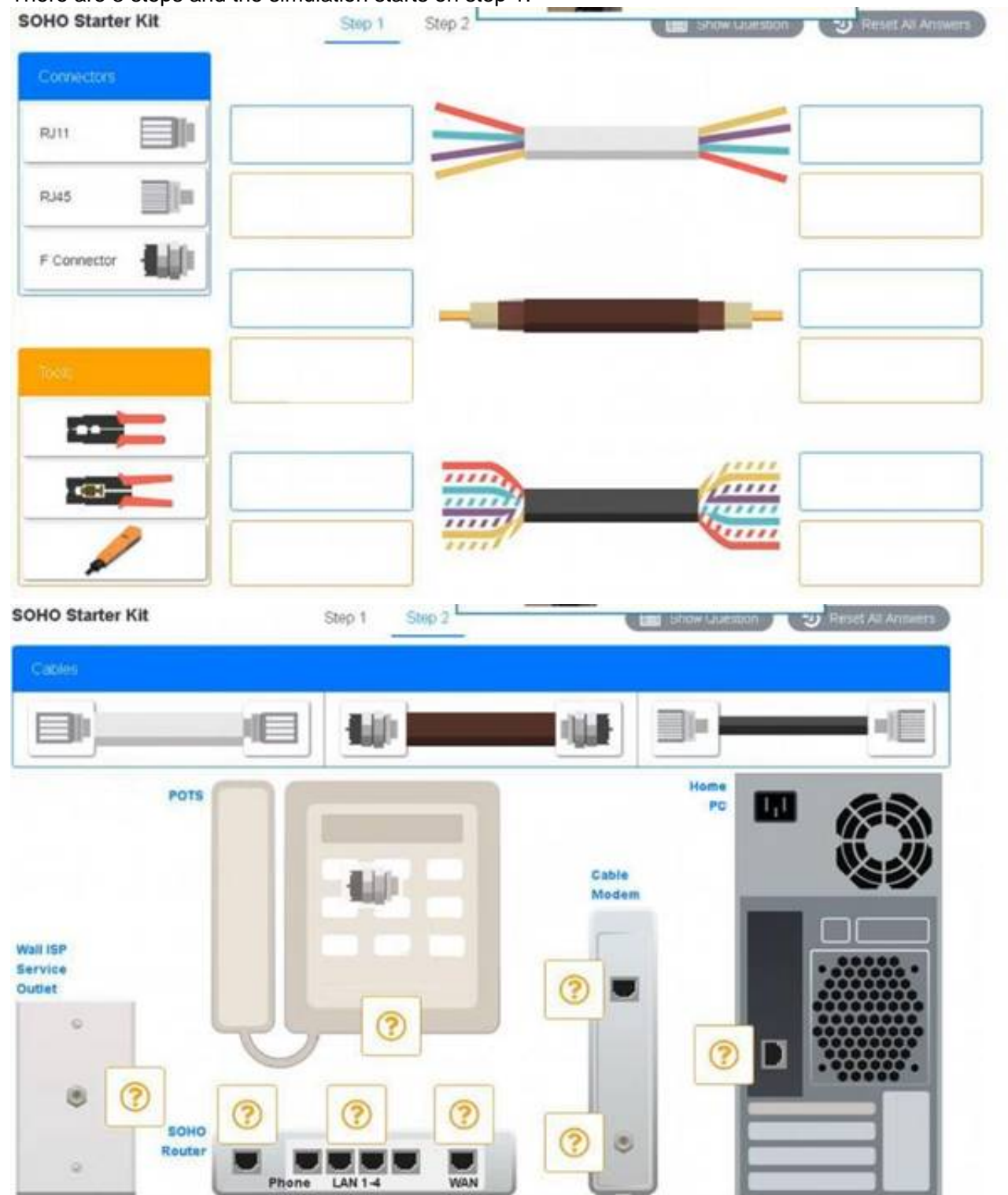

- A. Mastered
- B. Not Mastered

Answer: A

Explanation:

Answer of both steps below.

A picture containing text, screenshot, indoor Description automatically generated

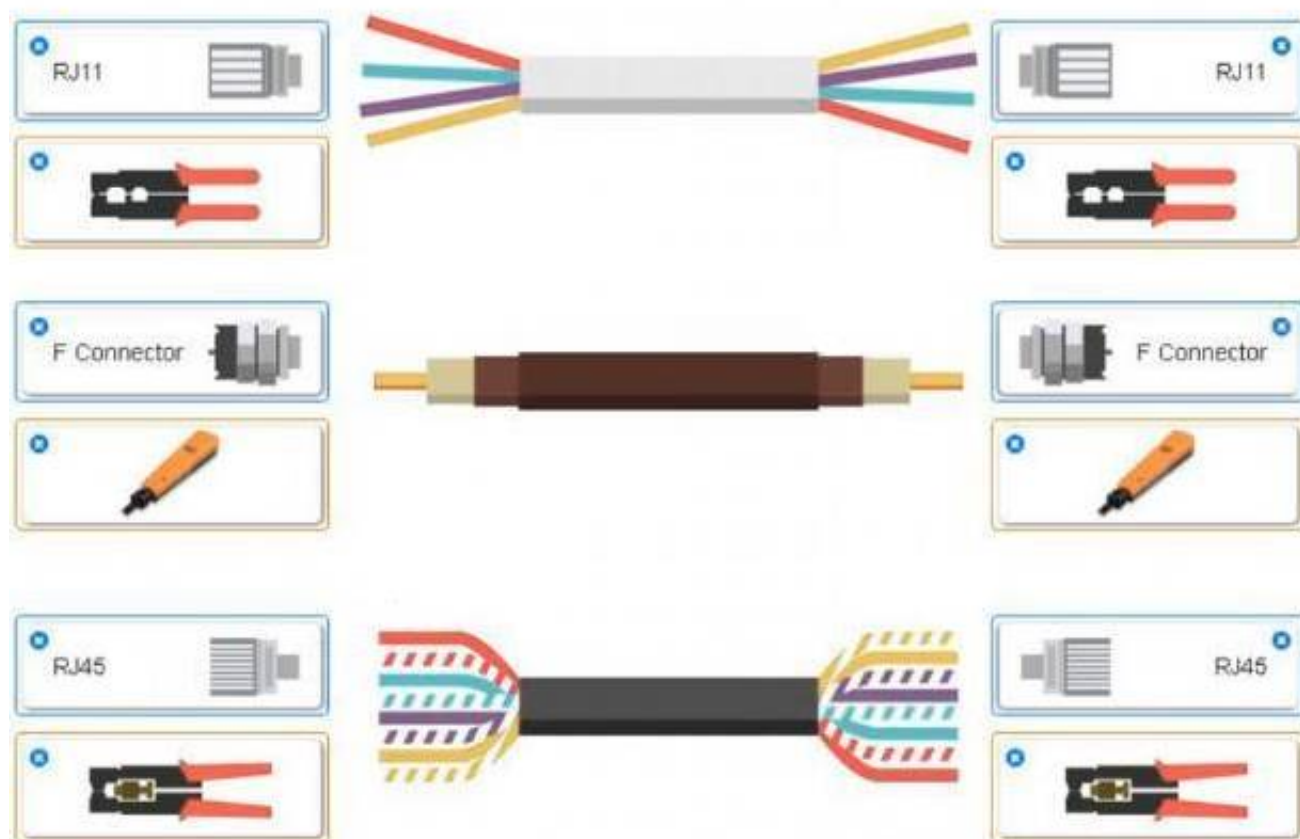
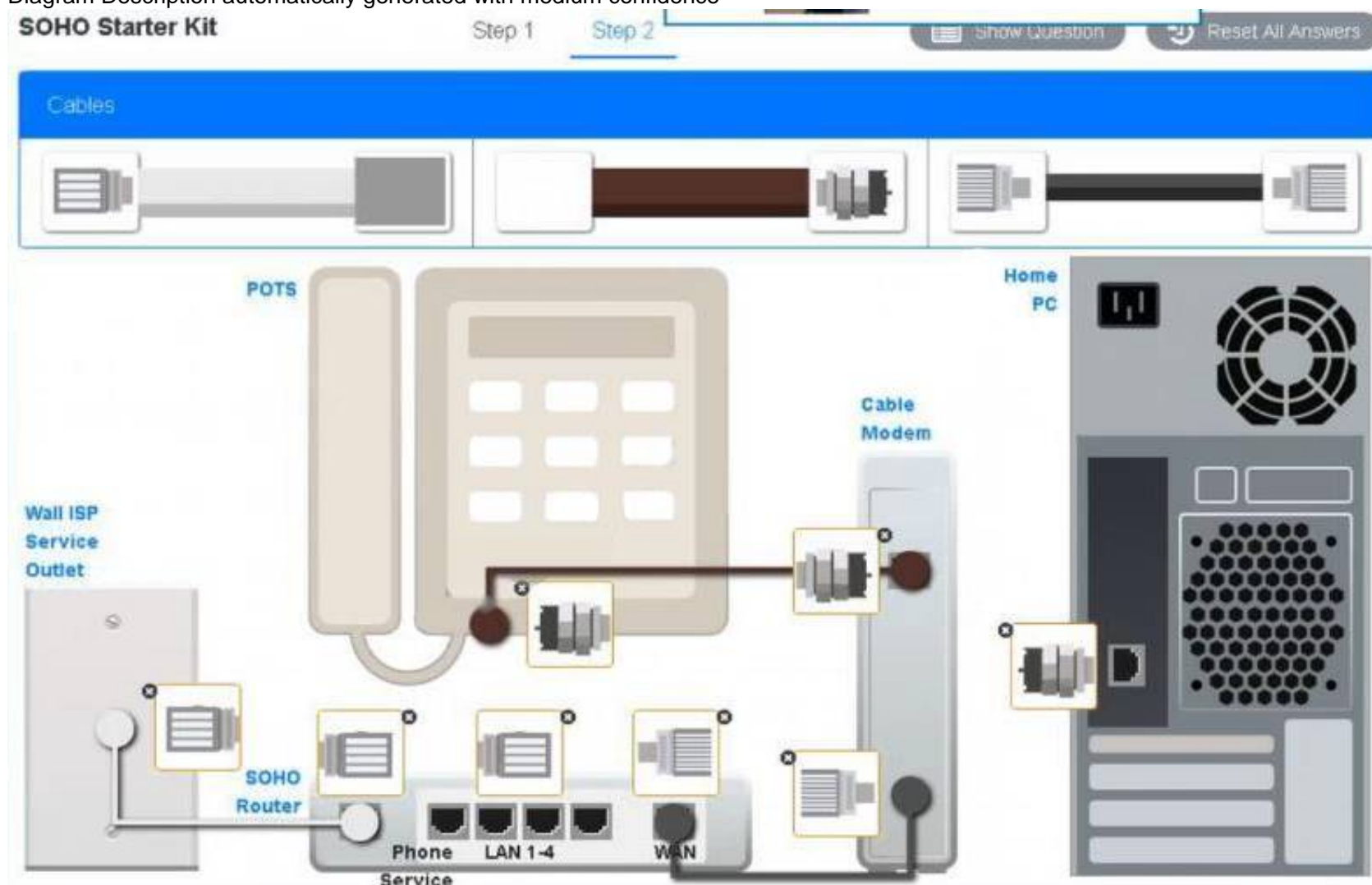

Diagram Description automatically generated with medium confidence



NEW QUESTION 97

A technician is upgrading a faulty motherboard that was ordered by an end user for an old, high-end desktop computer. However, the technician is unable to install the CPU into the socket. Upon closer inspection, the technician notices the pins on the CPU do not line up with the socket. Which of the following would be the best course of action for the technician to take NEXT?

- A. Try to set as many pins as possible.
- B. Install an adaptor to create a universal socket.
- C. Verify the socket type and manufacturer.
- D. Find a compatible motherboard for the CPU.

Answer: C

Explanation:

you need to know the socket type before you can go and find the replacement motherboard

NEW QUESTION 99

The IT department at an insurance brokerage needs to acquire laptops that have built-in fingerprint readers in order to create a more secure environment. Which of the following would be the MOST secure way to implement the fingerprint readers?

- A. Grant all registered employees access to each machine.
- B. Restrict device access to only the user to whom the laptop is assigned.

- C. Limit device access to departments and guest users.
- D. Give each team member a USB drive that bypasses the reader to allow guest users to log in.

Answer: B

NEW QUESTION 104

A user reports that printed receipts have black smudges over the entire image. The text is still present but is very dark and sometimes illegible. Which of the following are the MOST likely cause and solution for the printer issue?

- A. The ribbon is jammed and is rubbing on the paper
- B. Clear the bad ribbon and feed it through properly.
- C. The printhead is too hot
- D. Adjust the temperature down and retry printing.
- E. The printer is loaded with the wrong type of paper
- F. Replace the receipt paper with carbon paper.
- G. The blue ink cartridge was loaded with black ink
- H. Put in the correct ink and clean the printhead.

Answer: B

Explanation:

Receipts are printed via a thermal printer. Thermal printers work by heating a paper in specified areas in order to create an image. The specific component that does this is a thermal printhead. Since the image appears to have black smudges and is too dark, we know the thermal printhead is too hot since the capability of precise heating has diminished

NEW QUESTION 109

A startup is looking to immediately expand its data center but does not have the personnel or space to manage everything internally. The organization has multiple small offices and remote users with large computational and storage-solution requirements. Funding is not an issue for the company. Which of the following can BEST accomplish the company's goals?

- A. SaaS
- B. IaaS
- C. ISP
- D. SON

Answer: B

NEW QUESTION 114

A colleague has a laptop that has been working as expected for several years but will not power on. The MOST likely component that needs to be replaced is the:

- A. power adapter.
- B. battery.
- C. system fan.
- D. hard drive.

Answer: B

NEW QUESTION 116

A technician just finished assembling a new PC for a client. Upon POST, the device presents an unspecified beep code and turns off automatically after five seconds. The technician double-checks the bill of materials for the new build and confirms all items have been installed. Which of the following should the technician do NEXT?

- A. Ensure thermal paste is being used on the CPU.
- B. Check to make sure that any video cards have auxiliary power cabling connected.
- C. Verify the header panel connector is properly connected.
- D. Spot-check that the I/O shield for the motherboard is properly installed.

Answer: C

Explanation:

The technician should verify the header panel connector is properly connected. A beep code is a diagnostic tool used by motherboards to indicate issues with hardware components. This beep code may be indicating an issue with the connection between the motherboard and the case's header panel connector. This connector is responsible for providing power to the system and any connected peripherals. Therefore, the technician should verify the connection is secure and properly connected before attempting any other troubleshooting steps.

NEW QUESTION 117

A technician is replacing the RAM on an entry-level server with hot-swappable components. Which of the following should the technician do NEXT?

- A. Replace the RAM while the server is at a cool temperature
- B. Replace the RAM while the server is running
- C. Power down the server completely and then replace the RAM
- D. Verify that the OS supports hot swapping the RAM

Answer: C

NEW QUESTION 122

Which of the following would be BEST reason to use a virtual machine as a sandbox?

- A. To test new software in a safe environment
- B. To increase the efficient use of computing resources
- C. To run multiple machines on the same hardware
- D. To have dedicated hardware for a single system

Answer: A

NEW QUESTION 127

A user is trying to play a DVD on a projector. The user can hear the audio; however, the projector is showing an error message that states:

HDMI Blocked due to Copy Protection

Which of the following is the MOST likely cause of the error?

- A. The HDMI cannot carry the signal from the DVD to the projector.
- B. The user needs to switch from HDMI to a cable standard such as DisplayPort.
- C. The projector does not support the necessary HDCP protocol.
- D. The user needs to enable copy-protected sources in the projector's settings.

Answer: C

Explanation:

The Official CompTIA® A+® Core 1 and Core 2 Student Guide (Exams 220-1001 and 220-1002) | 193 Protected content. If you encounter an error that indicates unauthorized content or an HDCP error: • DVI, HDMI, DisplayPort, and Thunderbolt all provide support for the Digital Rights Management (DRM) mechanism High-bandwidth Digital Content Protection (HDCP). HDCP allows a content source (such as a Blu-ray disc) to disable itself if the display adapter and monitor and/or speaker system do not support HDCP and fail to authenticate themselves with the playback source. There have been various iterations of HDCP (at time of writing the current version is 2.2) and backward-compatibility can be problematic as authentication may fail between devices that support different versions of the standard.

NEW QUESTION 128

Which of the following are default ports for HTTP and HTTPS traffic? (Select TWO).

- A. 23
- B. 25
- C. 80
- D. 143
- E. 389
- F. 443

Answer: CF

NEW QUESTION 133

.....

THANKS FOR TRYING THE DEMO OF OUR PRODUCT

Visit Our Site to Purchase the Full Set of Actual 220-1101 Exam Questions With Answers.

We Also Provide Practice Exam Software That Simulates Real Exam Environment And Has Many Self-Assessment Features. Order the 220-1101 Product From:

<https://www.2passeasy.com/dumps/220-1101/>

Money Back Guarantee

220-1101 Practice Exam Features:

- * 220-1101 Questions and Answers Updated Frequently
- * 220-1101 Practice Questions Verified by Expert Senior Certified Staff
- * 220-1101 Most Realistic Questions that Guarantee you a Pass on Your FirstTry
- * 220-1101 Practice Test Questions in Multiple Choice Formats and Updatesfor 1 Year