

PL-900 Dumps

Microsoft Power Platform Fundamentals

<https://www.certleader.com/PL-900-dumps.html>



NEW QUESTION 1

- (Exam Topic 1)

You manage the support team at a rapidly growing company.

Customers and support technicians need a better experience when logging and responding to support requests. You need more visibility into what the support technicians are doing every week.

You need to recommend tools to help the company's needs.

Which tools should you recommend? To answer, drag the appropriate tools to the correct requirements. Each tool may be used once, more than once, or not at all.

You may need to drag the split bar between panes or scroll to view content.

NOTE: Each correct selection is worth one point.

Tools

Answer Area

Tools	Requirement	Tool
Power Apps	Customers must be able to submit support requests by using a website.	Tool
Microsoft Flow		Tool
Power BI		Tool
Common Data Service		Tool
	Support requests must be created and stored.	Tool
	Support technicians must be notified when a new support request is entered.	Tool
	Support technicians must be able to enter a status report for work completed during the previous week by using a mobile app.	Tool

- A. Mastered
- B. Not Mastered

Answer: A

Explanation:

Requirement	Tool
Customers must be able to submit support requests by using a website.	Power BI
Support requests must be created and stored.	Common Data Service
Support technicians must be notified when a new support request is entered.	Microsoft Flow
Support technicians must be able to enter a status report for work completed during the previous week by using a mobile app.	Power Apps

NEW QUESTION 2

- (Exam Topic 1)

A large retail company implements Power Apps, Microsoft Flow, and the Common Data Service.

The board of directors is asking whether users are finding value in the technology. The company would like to measure and report usage of the software.

You need to recommend a tool to determine software usage. What should you recommend?

- A. Microsoft Intune
- B. Azure Stream Analytics
- C. Power Platform Analytics
- D. Dynamics 365 Product Insights

Answer: C

Explanation:

The Power Platform Analytics Usage report is the default reports seen by the logged in environment admin. It provides total app launches and daily active users across all apps in the environment. Admins can filter the view with attributes like device platform, player version, country, state, and city.

Reference:

<https://docs.microsoft.com/en-us/power-platform/admin/analytics-powerapps>

NEW QUESTION 3

- (Exam Topic 1)

You create a user-owned custom entity by using Common Data Service.

For each of the following statements, select Yes if the statement is true. Otherwise, select No. NOTE: Each correct selection is worth one point.

Statement	Yes	No
You can change the entity ownership from User to Organization-owned.	<input type="radio"/>	<input type="radio"/>
You can create a business rule for a custom entity that can be used in a Flow.	<input type="radio"/>	<input type="radio"/>

- A. Mastered

B. Not Mastered

Answer: A

Explanation:

Box 1: No

Common Data Service supports two types of record ownership. Organization owned, and User or Team owned. This is a choice that happens at the time the entity is created and can't be changed.

Box 2: Yes

By combining conditions and actions, you can do any of the following with business rules: Set field values

Clear field values

Set field requirement levels Show or hide fields

Enable or disable fields

Validate data and show error messages

Create business recommendations based on business intelligence. Reference:

<https://docs.microsoft.com/en-us/power-platform/admin/wp-security-cds>

NEW QUESTION 4

- (Exam Topic 1)

A distribution company has multiple warehouses.

Tax rates charged on sales orders need to be calculated based on locality and region. You need to recommend a cost-effective solution that can be implemented quickly. What should you recommend?

A. Check AppSource for a tax add-on.

B. Create alerts in Dynamics 365 Finance for tax table changes.

C. Implement the Common Data Model.

D. Run a Power BI report.

E. Write scripts and code tax updates.

Answer: B

Explanation:

Reference:

<https://docs.microsoft.com/en-us/dynamics365/finance/general-ledger/indirect-taxes-overview>

NEW QUESTION 5

- (Exam Topic 2)

A company uses Microsoft 365 and Dynamics 365 Sales. The company does not have any developers on its staff.

You need to explain to the executives the benefits of using Power Platform apps. What are two benefits? Each correct answer presents a complete solution.

NOTE: Each correct selection is worth one point.

A. Users can send emails from Dynamics 365 Sales to their personal email addresses.

B. Users can create Power Apps to create apps for different departments.

C. Users can use Power Automate to share information between Microsoft 365 and Dynamics 365 Sales.

D. The company must unify all the mobile devices to one vendor.

Answer: BC

NEW QUESTION 6

- (Exam Topic 2)

You are creating a model-driven Power Apps app. You want to ensure that the app can be used by individuals who have vision impairments.

For each of the following statements, select Yes if the statement is true. Otherwise, select No. NOTE: Each correct selection is worth one point.

Statement	Yes	No
Power Apps apps can be built with hot key support and designed so they do not require a touch screen or mouse.	<input type="radio"/>	<input type="radio"/>
Only model-driven Power Apps have support for using a screen reader without the need for a connector.	<input type="radio"/>	<input type="radio"/>
The accessibility checker can be run for your Power Apps app to provide notifications of accessibility violations as well as tips for making it even more user friendly.	<input type="radio"/>	<input type="radio"/>

A. Mastered

B. Not Mastered

Answer: A

Explanation:

Box 1: Yes

You can use keyboard shortcuts in PowerApps. Keyboard shortcuts give you an alternate way to do common tasks instead of using your mouse or tapping with your finger. They help in seamless navigation of the interface.

Box 2: No

The following software combinations are the supported recommendations for consuming PowerApps with a screen reader:

Windows: Microsoft Edge / Narrator macOS: Safari / VoiceOver Android: PowerApps app / Talkback iOS: PowerApps app / VoiceOver

Box 3: Yes
Users who have vision, hearing, or other impairments can use your canvas app more easily and successfully if you consider accessibility as you design how the app looks and behaves. If you're not sure how to make your app more accessible, you can run the Accessibility checker in PowerApps Studio. This tool not only finds potential accessibility issues but also explains why each might be a potential problem for users who have a specific disability and offers suggestions on how to resolve each issue. The Accessibility checker detects screen-reader and keyboard issues for you, and you can find information about how to fix color-contrast issues by using accessible colors.

Reference:

<https://docs.microsoft.com/en-us/powerapps/user/keyboard-shortcuts> <https://docs.microsoft.com/en-us/powerapps/user/screen-reader>

<https://docs.microsoft.com/en-us/powerapps/maker/canvas-apps/accessibility-checker>

NEW QUESTION 7

- (Exam Topic 2)

A company is evaluating Power Platform and has questions about the role that Common Data Service plays in using Power Apps and Power Automate.

For each of the following statements, select Yes if the statement is true. Otherwise, select No. NOTE: Each correct selection is worth one point.

Statement	Yes	No
Model-driven apps require a Common Data Service database.	<input type="radio"/>	<input type="radio"/>
A flow instance can only access one Common Data Service database.	<input type="radio"/>	<input type="radio"/>
Canvas apps require a Common Data Service database.	<input type="radio"/>	<input type="radio"/>

A. Mastered

B. Not Mastered

Answer: A

Explanation:

Statement	Yes	No
Model-driven apps require a Common Data Service database.	<input checked="" type="radio"/>	<input type="radio"/>
A flow instance can only access one Common Data Service database.	<input checked="" type="radio"/>	<input type="radio"/>
Canvas apps require a Common Data Service database.	<input checked="" type="radio"/>	<input type="radio"/>

NEW QUESTION 8

- (Exam Topic 2)

A toy company creates a text classification model in AI Builder to monitor customer feedback for specific key words.

When negative feedback is received for a toy, the company wants to proactively perform engineering reviews for the toy and schedule additional training sessions for workers who produce the toy.

What are two possible ways to achieve the goal? Each correct answer presents a complete solution. NOTE: Each correct selection is worth one point.

A. Create a canvas app.

B. Implement the Virtual Agent.

C. Build a Microsoft Flow.

D. Use the Common Data Model.

Answer: AC

Explanation:

A (not D): AI Builder comes with:

A ready-to-use business card reader available in canvas as well as in model-driven apps. Business card reader (Canvas)

Business card reader (Model-driven)

Additional canvas components to leverage your AI Builder form processing or object detection models canvas apps.

C: Use the results from your AI model across Power Platform to create end-to-end solutions that meet your

business needs, even if you have no coding skills. For example, create a flow that automates document processing in Power Automate, or an app created with

PowerApps that predicts whether a supplier will be out of compliance.

Reference:

<https://docs.microsoft.com/en-us/ai-builder/use-in-powerapps-overview>

NEW QUESTION 9

- (Exam Topic 2)

A company is evaluating ways that they can implement AI Builder.
For which two scenarios can you use AI Builder? Each correct selection presents a complete solution. NOTE: Each correct selection is worth one point.

- A. Send emails to all ai users who subscribe to a service.
- B. Synchronize data from an external database.
- C. Collect data from several data sources and display a dashboard that shows trending data.
- D. Interpret images and perform an action on the image.

Answer: BD

Explanation:

Reference:
<https://powerapps.microsoft.com/en-us/blog/introducing-ai-builder-for-powerplatform/>

NEW QUESTION 10

- (Exam Topic 2)
A company plans to implement solutions that use Common Data Service as a data storage. You need to recommend features to meet the company's needs. Which features should you recommend? To answer, drag the appropriate features to the correct requirements. Each feature may be used once, more than once, or not at all. You may need to drag the split bar between panes or scroll to view content.
NOTE: Each correct selection is worth one point.

Features		Requirement	Feature
business rules			
business process flows		Validate data across multiple fields and entities regardless of the app used to create data.	Feature
Common Data Model		Create visual guides to ensure that users enter data and perform tasks in a consistent manner.	Feature
		Accelerate development by using a standard set of entities for the most common scenarios.	Feature

- A. Mastered
- B. Not Mastered

Answer: A

Explanation:

Box 1: business rules
You can create business rules and recommendations to apply logic and validations without writing code or creating plug-ins. Business rules provide a simple interface to implement and maintain fast-changing and commonly used rules.
Box 2: business process flows
Flows Power Automate includes several types of processes, each designed for a different purpose:
➤ Automated flows. Create a flow that performs one or more tasks automatically after it's triggered by an event.
➤ Button flows. Perform repetitive tasks simply by tapping a button on your mobile device.
➤ Scheduled flows. Create a flow that performs one or more tasks on a schedule such as once a day, on a specific date, or after a certain time.
➤ Business process flows. Ensure that people enter data consistently and follow the same steps every time they work in an app by creating a business process flow.
➤ Workflows and actions. Dynamics 365 customizers may be familiar with the classic Common Data Service processes, which are workflows and actions.
Box 3: Common Data Model
Model-driven app design is a component-focused approach to app development. Model-driven app design doesn't require code and the apps you make can be simple or very complex. Unlike canvas app development where the designer has complete control over app layout, with model-driven apps much of the layout is determined for you and largely designated by the components you add to the app.
Reference:
<https://docs.microsoft.com/en-us/powerapps/maker/model-driven-apps/guide-staff-through-common-tasks-proce> <https://docs.microsoft.com/en-us/powerapps/maker/model-driven-apps/model-driven-app-overview>

NEW QUESTION 10

- (Exam Topic 2)
A company plans to use AI Builder to help improve business performance. You need to determine which AI Models are available for use. Which three types of models can you use? Each correct answer presents a complete solution. NOTE: Each correct selection is worth one point.

- A. linear regression
- B. binary classification
- C. object detection
- D. anomaly detection
- E. text classification

Answer: BCE

Explanation:

Reference:
<https://carldesouza.com/using-the-ai-builder-in-the-microsoft-power-platform-for-binary-classification/>

NEW QUESTION 13

- (Exam Topic 3)

A company plans to display support call metrics on a screen that is visible to all call center staff. You need to recommend solutions to meet the company's requirements.

What should you recommend? To answer, drag the appropriate components to the correct requirements. Each component may be used once, more than once, or not at all. You may need to drag the split bar between panes or scroll to view content.

NOTE: Each correct selection is worth one point.

Components

Tile

Theme

Template App

Alert

Treemap

DirectQuery

Page

Workspace

Answer Area

Requirement	Component
Display a chart with incoming calls versus wait time and pin the chart to a dashboard.	<div>Component</div>
Send a specific user a notification when the number of customer support calls waiting is over 20.	<div>Component</div>
Display metrics from different datasets that have related data.	<div>Component</div>

- A. Mastered
- B. Not Mastered

Answer: A

Explanation:

Reference:
<https://docs.microsoft.com/en-us/power-bi/create-reports/service-dashboard-tiles> <https://docs.microsoft.com/en-us/power-bi/create-reports/service-set-data-alerts>
<https://docs.microsoft.com/en-us/power-bi/visuals/power-bi-visualization-treemaps>

NEW QUESTION 14

- (Exam Topic 3)

You create a Power BI dashboard.

Match each option to its function. To answer, drag the appropriate option from the column on the left to its function on the right. Each option may be used once, more than once, or not at all.

NOTE: Each correct match is worth one point.

Products

Share

Embed

Get Data

Pin

Import

Answer Area

Requirement	Product
Ensure that coworkers can see the dashboard.	<div></div>
Display data from Microsoft Excel in the dashboard.	<div></div>
Add a report tile to the dashboard.	<div></div>

- A. Mastered
- B. Not Mastered

Answer: A

Explanation:

Reference:
<https://docs.microsoft.com/en-us/power-bi/service-set-data-alerts> <https://docs.microsoft.com/en-us/power-bi/service-analyze-in-excel> <https://docs.microsoft.com/en-us/power-bi/service-dashboard-pin-tile-from-report>

NEW QUESTION 19

- (Exam Topic 3)

You are a district manager for a large retail organization. You train each store manager to use Power BI to track sales and daily sales targets. A store manager remembers learning about the Analyze in Excel option but cannot find the option in their Power BI dashboard. You need to help the user resolve the issue. How should you advise the user?

- A. Install the Power BI Desktop app.
- B. Navigate to the report used by the dashboard.
- C. Select the Spotlight button on the dashboard tile.
- D. Subscribe to the dashboard and follow the email link.

Answer: B

Explanation:

Reference:
<https://docs.microsoft.com/en-us/power-bi/collaborate-share/service-analyze-in-excel>

NEW QUESTION 22

- (Exam Topic 3)

You create a Power BI dashboard that displays Common Data Model data. You need to share the Power BI dashboard with coworkers and allow the coworkers to

collaborate. What are two possible ways to achieve the goal? Each correct answer presents a complete solution. NOTE: Each correct selection is worth one point.

- A. Create a Power Automate flow to export the data into a SQL Server database.
- B. Publish the dashboard as an app to your coworkers.
- C. Export the data to Microsoft Exce
- D. Make required changes and then re-import the data.
- E. Create a Power BI workspace and grant coworkers permissions.

Answer: AB

Explanation:

Reference:

<https://docs.microsoft.com/en-us/power-bi/collaborate-share/service-create-the-new-workspaces>

NEW QUESTION 23

- (Exam Topic 3)

A manufacturing company uses Internet of Things (IoT) devices to monitor the temperature in different parts of their warehouse. The current IoT monitoring software is extremely outdated and is not user friendly.

You need to view near-real time information from the IoT devices in Power BI Service dashboards. Which tool should you use?

- A. Scheduled refresh dataset
- B. Streaming dataset
- C. Content Pack dataset
- D. Power BI dataflows
- E. Quick Insights

Answer: B

Explanation:

<https://docs.microsoft.com/en-us/power-bi/service-real-time-streaming>

<https://powerbi.microsoft.com/en-us/blog/using-power-bi-real-time-dashboards-to-display-iot-sensor-data-astep-by-step-tutorial/>

NEW QUESTION 26

- (Exam Topic 3)

A company plans to create an information portal that managers can use to view critical information about their teams.

You need to recommend the type of Power BI components that the company should use.

What should you recommend? To answer, drag the appropriate components to the correct requirements. Each component may be used once, more than once, or not at all. You may need to drag the split bar between panes or scroll to view content.

NOTE: Each correct selection is worth one point.

Component types	Answer Area	
	Requirement	Component type
Dashboard	Display data from a Microsoft Excel workbook that has multiple worksheets into one chart.	Component type
Report		Component type
		Component type
	Display the top departmental goal metrics and alert users when specific thresholds targets are met.	Component type
	Display Sales charts that can be filtered by region.	Component type

- A. Mastered
- B. Not Mastered

Answer: A

Explanation:

Box 1: Report

Reports are more detailed data displayed in many formats like chart, graphs list and in tabular, etc. Box 2: Dashboard

Dashboards are a business key performance indicator view where it displays key values that can change business profits and can be glanced at one screen.

Box 3: Report

Power BI dashboards cannot slice and dice, but reports have many ways to filter and slice.

Note: Power BI dashboards are one placeholder to display the most important decision-making facts to run a business. But reports are more detailed data displayed in many formats like chart, graphs list and in tabular, etc. Reports are based on one dataset or one business unit data for example reports of a store belonging to California.

Reference:

<https://www.educba.com/power-bi-dashboard-vs-report/>

NEW QUESTION 28

- (Exam Topic 3)

You are a district manager for a large retail company. You want to provide sales managers with deeper sales insights to ensure that they can make more informed decisions for their stores.

Store managers must be able to view data in near real-time.

You need to create and share a Power BI dashboard that can be used by the store managers.

Which tools can you use? To answer, drag the appropriate reporting types to the correct requirements. Each reporting type may be used once, more than once, or not at all. You may need to drag the split bar between panes or scroll to view content.

Reporting Types

Power BI Desktop only

Power BI Service only

Power BI Desktop or Power BI Service

Answer Area

Requirement

Create Power BI dashboards that contain a single store's sales information.

Share the dashboard with your retail managers.

Reporting type

Reporting type

Reporting type

- A. Mastered
- B. Not Mastered

Answer: A

Explanation:

Reference:
<https://docs.microsoft.com/en-us/power-bi/fundamentals/desktop-getting-started>

NEW QUESTION 30

- (Exam Topic 3)

A company uses Microsoft Excel workbooks to store consolidated sales data. Workbooks are stored on OneDrive for Business. Match each Power BI feature to its requirement. To answer, drag the appropriate features from the column on the left to its requirement on the right. Each option may be used once, more than once, or not at all.
NOTE: Each correct match is worth one point.

Features

Q&A

Mobile apps

Export to Excel

Get data from files

Answer Area

Requirement

Enable user-friendly reporting on phones.

Use natural language to query and aggregate data.

Feature

Feature

Feature

- A. Mastered
- B. Not Mastered

Answer: A

Explanation:

Reference:
<https://docs.microsoft.com/en-us/power-bi/consumer/mobile/mobile-reports-in-the-mobile-apps> [https://docs.microsoft.com/en-us/power-bi/create-reports/power-bi-tutorial-q-and-a#:~:text=Sometimes%20the%](https://docs.microsoft.com/en-us/power-bi/create-reports/power-bi-tutorial-q-and-a#:~:text=Sometimes%20the%20)

NEW QUESTION 35

- (Exam Topic 3)

You are using Dynamics 365 Sales. You need to pull data into a Power BI report for your team. The City and State columns must be combined to form one column on the report. Which function would you use? Each correct answer presents a complete solution. NOTE: Each correct selection is worth one point.

- A. Use Power Query to merge columns.
- B. Import the data.18912E1457D5D1DDCBD40AB3BF70D5D
- C. Export data to Microsoft Excel.
- D. Create a view.

Answer: A

Explanation:

Reference:
<https://docs.microsoft.com/en-us/power-bi/desktop-shape-and-combine-data>

NEW QUESTION 38

- (Exam Topic 3)

A recent update has been made to a canvas app. The update has caused a negative impact to users. You need to roll back the app to a previous version. What should you do?

- A. Restore the previous version of the app.
- B. Uninstall the app for all users and reinstall by using the previous versions' package.
- C. Deactivate the live app, import the previous version of the app, and then activate the app.
- D. Delete the app and create a new app based on the previous version.

Answer: A

Explanation:

Restore a canvas app to a previous version in PowerApps. Restore an app from your account

- > Open powerapps.com, and then click or tap Apps in the left navigation bar.
- > Near the right edge, click or tap the info icon for the app that you want to restore.
- > Click or tap the Versions tab, and then click or tap Restore for the version that you want to restore.
- > In the confirmation dialog box, click or tap Restore.

A new version is added to your list. Reference:

<https://docs.microsoft.com/en-us/powerapps/maker/canvas-apps/restore-an-app>

NEW QUESTION 43

- (Exam Topic 4)

A company plans to implement Power Apps in a Power Platform environment. You need to implement other required components.

Match each option to its function. To answer, drag the appropriate option from the column on the left to its function on the right. Each option may be used once, more than once, or not at all.

NOTE: Each correct match is worth one point.

Products	Answer Area	
	Function	Product
Microsoft Azure	Implement user authentication.	<input type="text"/>
custom connector	Send data to a Microsoft OneNote notebook in the same tenant.	<input type="text"/>
Microsoft Flow		
model-driven app		
canvas app		

- A. Mastered
- B. Not Mastered

Answer: A

Explanation:

Reference:

<https://powerapps.microsoft.com/en-us/blog/implementing-role-based-permission/> <https://www.encorebusiness.com/blog/powerapps-flow-can/>

NEW QUESTION 47

- (Exam Topic 4)

A company plans to build Power Apps portals.

For each of the following statements, select Yes if the statement is true. Otherwise, select No. NOTE: Each correct selection is worth one point.

Statement	Yes	No
You must use standard templates for building portals.	<input type="radio"/>	<input type="radio"/>
You can test portals in non-prodcution environments and then migrate the portals into production environments.	<input type="radio"/>	<input type="radio"/>
When transitioning to the new version of a portal, you can display a customizable maintenance page until the new portal is ready to be used.	<input type="radio"/>	<input type="radio"/>

- A. Mastered
- B. Not Mastered

Answer: A

Explanation:

Reference:

<https://docs.microsoft.com/en-us/powerapps/maker/portals/overview> <https://docs.microsoft.com/en-us/powerapps/maker/portals/admin/migrate-portal-configuration>
<https://docs.microsoft.com/en-us/powerapps/maker/portals/admin/enable-maintenance-mode>

NEW QUESTION 51

- (Exam Topic 4)

A company uses Microsoft 365, Power Platform, and Dynamics 365. You do not assign permissions to any licensed users.

Users are able to create and edit Power Apps canvas apps.

In which environment are users creating and editing the apps?

- A. Production
- B. Default
- C. Sandbox

Answer: B

Explanation:

Reference:

<https://docs.microsoft.com/en-us/power-platform/admin/working-with-environments>

NEW QUESTION 56

- (Exam Topic 4)

A company is building a Power Apps Portals. You need to select page components.

Which components should you use? To answer, drag the appropriate components to the correct requirements.

Each component may be used once, more than once, or not at all. You may need to drag the split bar between panes or scroll to view content.

NOTE: Each correct selection is worth one point.

Components

list

form

Iframe

connector

Answer Area

Requirement	Component
Display a single record from Common Data Service.	<div>Component</div>
Display a list of records from a Microsoft SharePoint list.	<div>Component</div>
Display a list of records from Common Data Service.	<div>Component</div>

A. Mastered

B. Not Mastered

Answer: A

Explanation:

Reference:

<https://docs.microsoft.com/en-us/powerapps/maker/portals/compose-page>

<https://docs.microsoft.com/en-us/powerapps/maker/portals/compose-page#add-iframe>

NEW QUESTION 57

- (Exam Topic 4)

A user is creating their first canvas app in Power Apps.

The user does not know what types of controls they can include. You need to recommend solutions for the user.

Which types of controls would you recommend using in Power Apps? To answer, select the appropriate control in the dialog box in the answer area.

NOTE: Each correct selection is worth one point.

Scenario

View the date, time, and location of upcoming internal meetings.

Create a meeting request from within the app.

Drill down into customer contact records in Dynamics 365 Sales to view a photo of a customer you are meeting.

Control

Meeting-screen template

Gallery

List box

Meeting-screen template

Gallery

List box

Image

People-screen template

Add picture

A. Mastered

B. Not Mastered

Answer: A

Explanation:

Box 1: Gallery

A Gallery control can show multiple records from a data source, and each record can contain multiple types of data. For example, a Gallery control can show multiple contacts with each item showing contact information that includes a name, an address, and a phone number for each contact.

Box 2: Meeting-screen template

In a canvas app, add a meeting screen that lets users create and send meeting requests from their Office 365 Outlook accounts. Users can search for attendees in their org and add external email addresses. If your tenant has meeting rooms built into Outlook, users can select a location as well.

Box 3: Image

If you add one or more Image controls to your app, you can show individual images that aren't part of a data set, or you can incorporate images from records in data sources.

Reference:

<https://docs.microsoft.com/en-us/powerapps/maker/canvas-apps/screen-templates/meeting-screen-overview>

NEW QUESTION 58

- (Exam Topic 4)

A company plans to create canvas apps.

What is the minimum number of connectors required? To answer, drag the appropriate number of connectors to the correct drop scenarios. Each number of

The Leader of IT Certification

visit - <https://www.certleader.com>

connectors may be used once, more than once, or not at all. You may need to drag the split bar between panes or scroll to view content.
NOTE: Each correct selection is worth one point.

Number of connectors	Answer Area		Number of connectors
0		Scenario	
1		Synchronize data with three data sources that use different proprietary database formats.	
2		Create three Power Apps apps that each display data from a Microsoft SharePoint list.	
3		Create three Flows that each copy data to Microsoft Azure Data Lake on different schedules.	

- A. Mastered
- B. Not Mastered

Answer: A

Explanation:

Reference:
<https://docs.microsoft.com/en-us/powerapps/maker/canvas-apps/connections-list> <https://docs.microsoft.com/en-us/connectors/connectors>

NEW QUESTION 59

- (Exam Topic 5)
You plan to use Microsoft Flow to monitor what people are saying about your company's products. You store the feedback for research and development purposes.
You need to recommend Flow components to use for the solution.
To answer, drag the appropriate components to the correct requirements. Each component may be used once, more than once, or not at all. You may need to drag the split bar between panes or scroll to view content.
NOTE: Each correct selection is worth one point.

Components	Answer Area		
		Requirement	Component
action			
expression		Retrieve the top five posts from your company's Facebook page.	Component
service		Enter the resulting posts into the product database.	Component
trigger		Combine author and link fields into a single field.	Component
flow type		Run flow every hour.	Component

- A. Mastered
- B. Not Mastered

Answer: A

Explanation:

Box 1: Trigger
A trigger is something that triggers or starts the workflow. It could be a new file uploaded to a document library, a new item created in the list or an email sent to your Inbox – something that will start (kick-off the workflow).
There are two types of triggers:
➤ Automatic trigger is pre-programmed into the workflow based on a certain rule (i.e. new document or item created, email sent, etc.)
➤ Manual Trigger is a trigger initiated by a user. Unlike with automatic trigger above, the workflow will only start when initiated manually by the end user (for example, from the Document Library for a selected file). Manual trigger is only supported for certain types of workflows (i.e. Get feedback from your manager for the selected file)
Box 2: action
An action is something that occurs as a result of the workflow. Box 3: expression
Sometimes users just need to do basic operations like getting the current time, adding numbers together, or replacing a part of a string of text. That's possible inline in any flow action. Microsoft Flow leverages the same Workflow Definition Language used by Azure Logic apps. For new users who are unfamiliar with the expression language, there is an inline help experience that shows how to use each expression as they build out their flow.
Box 4: flow type
There are four different Flow types that you can choose from when starting out. You can create a scheduled flow, automated flow, instant flow, or a business process flow.
Reference:
<https://sharepointmaven.com/3-major-components-microsoft-flow/> <https://www.avepoint.com/blog/office-365/office-365-automation/> <https://flow.microsoft.com/de-de/blog/use-expressions-in-actions/>

NEW QUESTION 60

- (Exam Topic 5)

You plan to send an email notification to a user when a new file is placed in a specific folder in OneDrive for Business.

For each of the following statements, select Yes if the statement is true. Otherwise, select No. NOTE: Each correct selection is worth one point.

Statement	Yes	No
You can create a flow without writing a single line of code and deploy the flow to a production environment.	<input type="radio"/>	<input type="radio"/>
You cannot add additional actions to the built-in Power Automate templates.	<input type="radio"/>	<input type="radio"/>
You can view the code that implements workflow actions and triggers without installing additional software.	<input type="radio"/>	<input type="radio"/>

- A. Mastered
- B. Not Mastered

Answer: A

Explanation:

Reference:

<https://docs.microsoft.com/en-us/power-automate/getting-started> <https://docs.microsoft.com/en-us/power-automate/multi-step-logic-flow>

NEW QUESTION 62

- (Exam Topic 5)

A company uses Dynamics 365 Supply Chain Management.

You need to use Microsoft Flow to automate the process of receiving and tracking raw materials. Which type of connector should you use?

- A. Common Data Service
- B. Dynamics 365
- C. Dynamics 365 for Fin & Ops
- D. Dynamic Signal

Answer: A

Explanation:

Dynamics 365 for Finance and Operations is now being licensed as Dynamics 365 Finance and Dynamics 365 Supply Chain Management.

You can use Common Data Service to enable the flow of data between Finance and Operations apps and Dynamics 365 Sales.

Reference:

<https://docs.microsoft.com/en-us/dynamics365/fin-ops-core/dev-itpro/data-entities/data-integration-cds>

NEW QUESTION 63

- (Exam Topic 5)

You are learning about Power Apps and how to use triggers.

Which objects should you use? To answer, select the appropriate options in the answer area. NOTE: Each correct selection is worth one point.

Answer Area

Statement	Component
A Power Apps app can trigger this when a condition is met.	<div>connector <input type="checkbox"/></div> <div>Power Automate flow <input type="checkbox"/></div> <div>gateway <input type="checkbox"/></div> <div>solution <input type="checkbox"/></div>
Actions and triggers are properties of a	<div>connector <input type="checkbox"/></div> <div>gateway <input type="checkbox"/></div> <div>solution <input type="checkbox"/></div>

- A. Mastered
- B. Not Mastered

Answer: A

Explanation:

Answer Area

Statement	Component
A Power Apps app can trigger this when a condition is met.	<div>Power Automate flow <input type="checkbox"/></div>
Actions and triggers are properties of a	<div>connector <input type="checkbox"/></div>

NEW QUESTION 68

- (Exam Topic 5)

You build a flow using a template. You want to add support for additional business scenarios. You need to ensure that the new workflow does not break existing functionality.

Which flow editing utilities should you use? To answer, drag the appropriate tools to the correct requirements. Each tool may be used once, more than once, or not at all. You may need to drag the split bar between panes or scroll to view content.

NOTE: Each correct selection is worth one point.

Tools		Answer Area
	Requirement	Tool
Test		
Flow Checker	Check the new flow for any errors or warnings.	Tool
	Run the flow using previously processed data.	Tool
	Monitor the flow as it is running.	Tool

- A. Mastered
- B. Not Mastered

Answer: A

Explanation:

Box 1: Flow Checker

The Flow checker feature will promote higher quality flows by ensuring you follow best practices. By running the checker, you will be able to get answers to questions like: which areas of my flow implementation pose a performance or reliability risk?

For each issue identified, the Flow checker points to specific occurrences within the flow where improvements may be required. And more importantly, you learn how to implement these improvements by following detailed guidance.

Box 2: Test

Box 3: Test Reference:

<https://flow.microsoft.com/en-us/blog/flow-checker-four-connectors/> <https://docs.microsoft.com/en-us/power-automate/modern-approvals>

NEW QUESTION 71

- (Exam Topic 5)

A company uses Dynamics 365 Supply Chain Management.

When a sales order is created for one of the customers that a specific user manages, a Microsoft Outlook task must be created to remind the user to perform any follow up activities that are required.

You need to implement the functionality to create Outlook tasks.

Which two features should you use? Each correct answer presents part of the solution. NOTE: Each correct selection is worth one point.

- A. AI Builder
- B. Power Apps
- C. Business Events
- D. Microsoft Flow
- E. Common Data Service

Answer: CD

Explanation:

Business events in Microsoft Power Automate

Business events can be consumed in Microsoft Power Automate via the application connector. The connector has a trigger that is named when a business event occurs. This trigger can be used to subscribe to any of the business events that are available in the target instance of the application.

Reference:

<https://docs.microsoft.com/en-us/dynamics365/fin-ops-core/dev-itpro/business-events/business-events-flow>

NEW QUESTION 75

- (Exam Topic 5)

You have a Power Automate flow that saves attachments from emails into OneDrive for Business. You need to determine why the flow is not working.

What are three possible ways to achieve the goal? Each correct answer presents a complete solution. NOTE: Each correct selection is worth one point.

- A. Navigate to the Power Automate web portal and click view notifications.
- B. Enable Repair Tips for the flow.
- C. Navigate to the Action Items section of the Power Automate portal.
- D. Navigate to the Power Automate admin center and view the projects.
- E. Navigate to the flow and view the run history.

Answer: ABE

Explanation:

Reference:

<https://docs.microsoft.com/en-us/power-automate/fix-flow-failures>

NEW QUESTION 78

- (Exam Topic 5)

This question requires that you evaluate the BOLD text to determine if it is correct.
A company requires that service representatives schedule customer visits every six months. Each service representative is required to enter a scheduled task for the next checkup as they are leaving a client site. A service representative wants to automate task entry by creating a business process flow that can be initiated from the service call screen on a phone.
Review the underlined text. If it makes the statement correct, select “No change is needed.” If the statement is incorrect, select the answer choice that makes the statement correct.

- A. No change is needed.
- B. a scheduled
- C. an instant
- D. an action

Answer: D

Explanation:

Note: Create a flow (see step 6 below)

- * 1. Sign in to PowerApps.
 - * 2. In the left navigation bar, select Business logic, and then select Flows.
 - * 3. In the upper-left corner of the My Flows page, select New, and then select Create from blank.
 - * 4. Option to create a flow without using a template
- Near the bottom of the page that appears, select Search hundreds of connections and triggers.
- * 5. In the search box, type PowerApps, and then select the PowerApps icon.
 - * 6. Create a PowerApps trigger
 - * 7. On the next page, select the PowerApps icon again, and then select New step.
 - * 8. In the box that says Search connectors and actions, specify an action for your flow, as in this example:

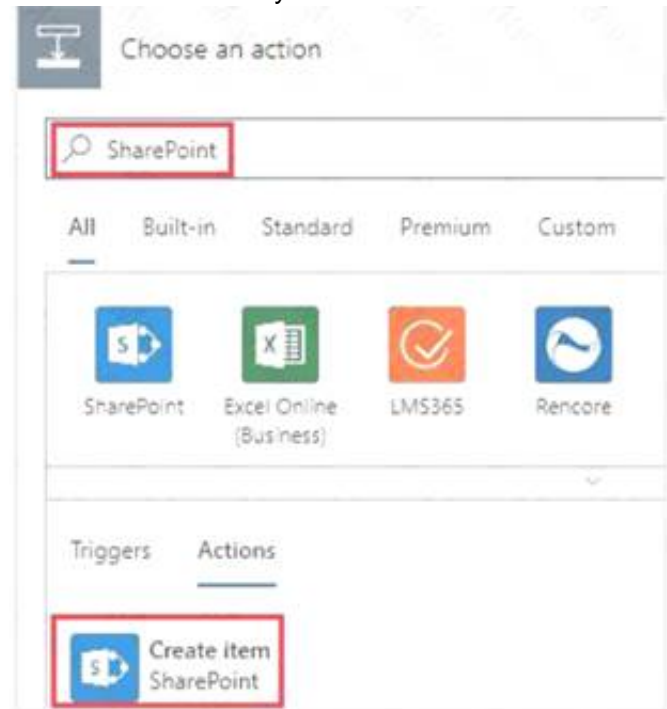

Reference:
<https://docs.microsoft.com/en-us/powerapps/maker/canvas-apps/using-logic-flows>

NEW QUESTION 83

- (Exam Topic 5)

For which scenarios can you use Power Automate?

For each of the following statements, select Yes if the statement is true. Otherwise, select No. NOTE: Each correct selection is worth one point.

Statement	Yes	No
Notify team members when a response is recorded in a form in Microsoft Forms.	<input type="radio"/>	<input type="radio"/>
When email is received, save email attachments to OneDrive for Business.	<input type="radio"/>	<input type="radio"/>
Receive notifications when negative comments about the company are posted on Twitter.	<input type="radio"/>	<input type="radio"/>

- A. Mastered
- B. Not Mastered

Answer: A

Explanation:

Reference:

<https://flow.microsoft.com/en-us/galleries/public/templates/b923bbd04bda11e78896d10a96d3fac3/notify-the-tea> <https://flow.microsoft.com/en-us/galleries/public/templates/65ceb79430ef4956a0855fbe09249cdf/save-office-36> <https://flow.microsoft.com/en-us/blog/get-notified-of-negative-posts/>

NEW QUESTION 88

- (Exam Topic 5)

A company performs on-site inspections and services for air industrial equipment. Field technicians must perform a series of maintenance checks every time they visit a customer site. Every technician performs maintenance tasks in a different order. Some technicians miss steps. You need to ensure that all technicians perform the same steps in the same order. What should you use?

- A. Business process flow
- B. AI Builder
- C. Business rule
- D. Virtual Agent

Answer: A

Explanation:

You can help ensure that people enter data consistently and follow the same steps every time they work with a customer by creating a business process flow. For example, you might want to create a business process flow to have everyone handle customer service requests the same way, or to require that people get approval for an invoice before submitting an order. Business process flows use the same underlying technology as other processes, but the capabilities that they provide are very different from other features that use processes.

Reference:

<https://docs.microsoft.com/en-us/power-automate/business-process-flows-overview>

NEW QUESTION 91

- (Exam Topic 5)

A company has a website. The website includes a form that allows the company to collect information about leads. You need to set up an automated workflow to create leads in Dynamics 365 Sales when leads are created on the company's custom website. What should you create?

- A. Task Flow
- B. Power Automate flow
- C. Dynamics 365 workflow
- D. Business Process Flow

Answer: B

Explanation:

Reference:

<https://trellispoint.com/create-crm-leads-using-microsoft-flow/>

NEW QUESTION 96

- (Exam Topic 6)

You are creating a Power Automate flow. You need to retrieve data from several sources including Microsoft Excel, Azure Data lake, and GitHub. What should you use? To answer, drag the appropriate components to the correct data sources. Each component may be used once, more than once, or not at all. You may need to drag the split bar between panes or scroll to view content. NOTE: Each correct selection is worth one point

Components	Answer Area	
	Data source	Component
Connector	Microsoft Excel	
Expression	Azure Data Lake	
Formula	GitHub	

- A. Mastered
- B. Not Mastered

Answer: A

Explanation:

Components	Answer Area	
	Data source	Component
Connector	Microsoft Excel	Formula
Expression	Azure Data Lake	Connector
Formula	GitHub	Expression

NEW QUESTION 99

- (Exam Topic 6)

You want to create a Power Apps app that allows you to define a custom Sitemap. What should you do? To answer, select the appropriate options in the answer area.

- a canvas app.
- a model-driven app.
- a portal app.
- an app by using a template.

- Answer: A**

<https://docs.microsoft.com/en-us/powerapps/powerapps-overview>

For each of the following statements, select Yes if the statement is true. Otherwise, select No. NOTE: Each correct selection is worth one point.

Statement	Yes	No
Power Virtual Agents chat data is saved unless it is deleted by the customer after a chat session.	<input type="radio"/>	<input type="radio"/>
Power Automate flows operate with administrative privileges at all times.	<input type="radio"/>	<input type="radio"/>

- Answer: A**

Statement	Yes	No
Power Virtual Agents chat data is saved unless it is deleted by the customer after a chat session.	<input checked="" type="radio"/>	<input type="radio"/>
Power Automate flows operate with administrative privileges at all times.	<input type="radio"/>	<input checked="" type="radio"/>

NOTE: Each correct selection is worth one point

Scenario	Tool
Field technicians need a mobile app to capture the location and the image of defective products.	<ul style="list-style-type: none"> Canvas app Power Apps Portals Common Data Service
Sales representatives need to see different views and dashboards in the sales app.	<ul style="list-style-type: none"> Canvas app Model-driven app Power Apps Portals

- Answer: A**

Explanation:

Answer Area

Scenario

Field technicians need a mobile app to capture the location and the image of defective products.
Sales representatives need to see different views and dashboards in the sales app.

Tool

Canvas app

Power Apps Portals

Common Data Service

Canvas app

Model-driven app

Power Apps Portals

NEW QUESTION 107
- (Exam Topic 6)
You need to explain the major components of the Common Data Model (CDM) and their functions. Match each term to its definition.
Instructions: To answer, drag the appropriate term from the column on the left to its definition on the right. Each term may be used once, more than once, or not at all. Each correct match is worth one point.
NOTE: Each correct selection is worth one point.

Tools

Entities

Common Data Service

Workflows

Data connectors

Common Data Model

Answer Area

Purpose

Helps jumpstart application development by leveraging business logic, security, and integrations

A set of records used to store data

Tool

- A. Mastered
- B. Not Mastered

Answer: A

Explanation:

Tools

Entities

Common Data Service

Workflows

Data connectors

Common Data Model

Answer Area

Purpose

Helps jumpstart application development by leveraging business logic, security, and integrations

A set of records used to store data

Tool

Common Data Service

Entities

NEW QUESTION 109
- (Exam Topic 6)
You are a retail director for a large clothing company. Each week you use the corporate YouTube channel to create a video that highlights new initiatives, and goals for retail operations.
You need to design a Power Apps app that streams the videos to internal users.
Which objects should you use? To answer, select the appropriate options in the answer area.
NOTE: Each correct selection is worth one point.

Action

Implement the Power Apps app.

Option

Canvas

Model-driven

Portal

Action

Use drag and drop to add a video to the app.

Option

View

Connector

Control

Action

Apply consistent company colors to the app.

Option

Unified Interface

Control

Theme

Template

- A. Mastered
- B. Not Mastered

Answer: A

Explanation:

Reference:

<https://powerapps.microsoft.com/en-us/blog/microsoft-stream-videos-and-channels-in-canvas-apps/> <https://docs.microsoft.com/en-us/powerapps/maker/model-driven-apps/create-themes-organization-branding> <https://docs.microsoft.com/en-us/powerapps/maker/canvas-apps/controls/control-stream-video>

NEW QUESTION 110

- (Exam Topic 6)

A company plans to use Power Automate to automate tasks.

Match each flow type to its description to answer, drag the appropriate flow type from the column on the left to its description on the right. Each option may be used once, more than once, or not at all.

NOTE: Each correct match is worth one point.

Flow types	Answer Area	Description	Flow type
automated		a flow that runs after it is triggered by an event	Flow type
business process		a flow that guides a user through a set of tasks	Flow type
scheduled		a flow that runs after a specified number of days	Flow type
instant		a flow that allows you to start tasks on demand	Flow type

A. Mastered

B. Not Mastered

Answer: A

Explanation:

Flow types	Answer Area	Description	Flow type
automated		a flow that runs after it is triggered by an event	automated
business process		a flow that guides a user through a set of tasks	business process
scheduled		a flow that runs after a specified number of days	scheduled
instant		a flow that allows you to start tasks on demand	instant

NEW QUESTION 115

- (Exam Topic 6)

You are authoring a Power Virtual Agents chatbot for a company.

For each of the following statements, select Yes if the statement is true. Otherwise, select No.

NOTE: Each correct selection is worth one point.

Statements	Yes	No
You must create a custom action to display a knowledge base article that answers a common support question.	<input type="radio"/>	<input type="radio"/>
You can use Power Automate to retrieve a customer's contact number in order to verify they are an authorized user and their support plan SLA.	<input type="radio"/>	<input type="radio"/>

A. Mastered

B. Not Mastered

Answer: A

Explanation:

Reference:

<https://docs.microsoft.com/en-us/azure/cognitive-services/qnamaker/tutorials/integrate-with-power-virtual-assist> <https://docs.microsoft.com/en-us/power-virtual-agents/advanced-flow>

NEW QUESTION 117

- (Exam Topic 6)

You are creating a Power Automate approval flow.

Instructions: For each of the following statements, select Yes if the statement is true. Otherwise, select No.

NOTE: Each correct selection is worth one point.

Statements	Yes	No
The addition of an expense report to a Microsoft OneDrive folder can initiate an approval flow.	<input type="radio"/>	<input type="radio"/>
Approvals must follow a sequential order of approval.	<input type="radio"/>	<input type="radio"/>

- A. Mastered
B. Not Mastered

Answer: A

Explanation:

Box 1: Yes

Box 2: No

Parallel approvals, integrated approvals, and unanimous approvals are also allowed. Reference:

<https://docs.microsoft.com/en-us/power-automate/modern-approvals> <https://docs.microsoft.com/en-us/power-automate/create-approval-response-options>

NEW QUESTION 118

- (Exam Topic 6)

A medical office has a model -driven app that uses Common Data Service.

You plan to create a screen that allows users to capture information about doctors. The screen must provide users the ability to enter or select the following information;

- > a place to enter doctor- profile data that is not pan of the account table or the contact table.
- > a place to enter the doctor's specialty in the profile form.
- > a column for insurance with the ability to pick one of 10 different insurance companies. You need to store the captured data in Common Data Service.

What should you use to store the data? To answer, drag the appropriate components to the correct requirements. Each component may be used once, more than once, or not at all You may need to drag the split bar between panes or scroll to view content.

NOTE: Each correct selection is worth one point.

Options	Requirement	Option
Entity	Store additional doctor profile data.	Option
Field	Store information about the doctor's specialty.	Option
Option set	Select an insurance company.	Option
Record		

- A. Mastered
B. Not Mastered

Answer: A

Explanation:

Options	Requirement	Option
Entity	Store additional doctor profile data.	Record
Field	Store information about the doctor's specialty.	Entity
Option set	Select an insurance company.	Option set
Record		

NEW QUESTION 123

- (Exam Topic 6)

A company uses Power Apps canvas apps.

When a user opens Power Apps Studio in a browser and selects Apps I can edit, they do not see an app that they need to modify.

You need to determine why the user cannot see the app.

What are three possible reasons? Each correct answer presents a complete solution. NOTE: Each correct selection is worth one point.

- A. The user selected an incorrect Power Apps environment.
B. The user has not been granted the System Customizer role.
C. The user has not been set as the app co-owner.
D. The app has not been shared with the user.
E. The environment does not have a Common Data Service database.

Answer: ACD

Explanation:

Reference:

<https://docs.microsoft.com/en-us/powerapps/maker/canvas-apps/edit-app>

NEW QUESTION 127

- (Exam Topic 6)

You are building Power BI visualizations for a team.

For each of the following statements, select Yes if the statement is true. Otherwise, select No. NOTE: Each correct selection is worth one point.

Answer Area

Statement	Yes	No
Power BI can only retrieve data from up to two different sources for each dashboard.	<input type="radio"/>	<input type="radio"/>
Power BI visualizations can be used in canvas apps and model driven apps.	<input type="radio"/>	<input type="radio"/>
Power BI can display charts and list boxes on dashboards.	<input type="radio"/>	<input type="radio"/>

- A. Mastered
- B. Not Mastered

Answer: A

Explanation:

Yes

Yes Yes

NEW QUESTION 132

- (Exam Topic 6)

Match each tool to its task. To answer, drag the appropriate tool from the column on the left to its task on the right. Each tool may be used once, more than once, or not at all. NOTE: Each correct match is worth one point.

Tools

Power BI

Power Automate

Power Apps

Answer Area

Task

Automate workflows.

Trigger an action from an event.

Create a custom mobile data entry screen.

Tool

Tool

Tool

Tool

- A. Mastered
- B. Not Mastered

Answer: A

Explanation:

Reference:

<https://docs.microsoft.com/en-us/power-automate/getting-started> <https://docs.microsoft.com/en-us/powerapps/maker/portals/compose-page#add-form>

NEW QUESTION 134

- (Exam Topic 6)

You are authoring a Power Virtual Agents chatbot for a company for each of the following statements, select Yes if the statement is true. Otherwise, select No.

NOTE: Each correct selection is worth one point.

Statement	Yes	No
When escalating to a live person from a chatbot, the customer must restate their issue and other information collected.	<input type="radio"/>	<input type="radio"/>
You can customize the greeting topic for every chatbot that you author.	<input type="radio"/>	<input type="radio"/>

- A. Mastered
- B. Not Mastered

Answer: A

Explanation:

Statement	Yes	No
When escalating to a live person from a chatbot, the customer must restate their issue and other information collected.	<input checked="" type="radio"/>	<input type="radio"/>
You can customize the greeting topic for every chatbot that you author.	<input checked="" type="radio"/>	<input type="radio"/>

NEW QUESTION 139

- (Exam Topic 6)

Match each tool to its task. To answer, drag the appropriate tool from the column on the left to its task on the right. Each tool may be used once, more than once, or not at all.

NOTE: Each correct match is worth one point.

Tools	Answer Area	
	Task	
Power BI	Automate workflows.	Tool
Power Automate	Trigger an action from an event.	
Power Apps	Create a custom mobile data entry screen.	

- A. Mastered
B. Not Mastered

Answer: A

Explanation:

Tools	Answer Area	
	Task	
Power BI	Automate workflows.	Tool
Power Automate	Trigger an action from an event.	Power Automate
Power Apps	Create a custom mobile data entry screen.	Power BI Power Apps

NEW QUESTION 144

- (Exam Topic 6)

A company is creating a canvas app to manage weekly status reports from users about projects.

Status reports must be created weekly. Users can enter project tasks with descriptions. Users can also add escalation requests for tasks that are late or at risk.

When a status report is submitted with an escalation request the app must automatically send a text message to the submitter's manager. A reminder must be sent at 8 PM on Sunday to everyone who has not yet submitted a status report for the previous week.

You need to identify the appropriate components to use in the solution.

What should you use? To answer, drag the appropriate implementation mechanisms to the correct requirements. Each implementation mechanism may be used once, more than once, or not at all. You may need to drag the split bar between panes or scroll to view content

NOTE: Each correct selection is worth one point

Implementation Mechanisms	Answer Area	
	Action	
Actions	Automatically send a text message based on the report submission.	Implementation Mechanism
Triggers	Automatically send a reminder at 8 PM based on a missing status report.	
Conditions		
Business process flows		

- A. Mastered
B. Not Mastered

Answer: A

Explanation:

Implementation Mechanisms	Answer Area	
	Action	
Actions	Automatically send a text message based on the report submission.	Implementation Mechanism
Triggers	Automatically send a reminder at 8 PM based on a missing status report.	Triggers
Conditions		Actions
Business process flows		

NEW QUESTION 147

- (Exam Topic 6)

You plan to use Power Automate to monitor what people are saying about your company's products. You store the feedback for research and development purposes.

You need to recommend Power Automate components to use for the solution.

To answer drag the appropriate components to the correct requirements. Each component may be used once, more than once, or not at all. You may need to drag the split bar between panes or scroll to view content.

NOTE: Each correct selection is worth one point

Components

action

expression

service

trigger

Answer Area

Requirement

Retrieve the top five posts from your company's Facebook page.
Enter the resulting posts into the product database.
Combine author and link fields into a single field.
Run a flow every hour.

Component

Component

Component

Component

Component

A. Mastered

B. Not Mastered

Answer: A

Explanation:

Components

action

expression

service

trigger

Answer Area

Requirement

Retrieve the top five posts from your company's Facebook page.
Enter the resulting posts into the product database.
Combine author and link fields into a single field.
Run a flow every hour.

Component

action

action

expression

trigger

NEW QUESTION 150

.....

The Leader of IT Certification

visit - <https://www.certleader.com>

Thank You for Trying Our Product

* 100% Pass or Money Back

All our products come with a 90-day Money Back Guarantee.

* One year free update

You can enjoy free update one year. 24x7 online support.

* Trusted by Millions

We currently serve more than 30,000,000 customers.

* Shop Securely

All transactions are protected by VeriSign!

100% Pass Your PL-900 Exam with Our Prep Materials Via below:

<https://www.certleader.com/PL-900-dumps.html>