



Microsoft

Exam Questions AI-102

Designing and Implementing an Azure AI Solution

About ExamBible

[Your Partner of IT Exam](#)

Found in 1998

ExamBible is a company specialized on providing high quality IT exam practice study materials, especially Cisco CCNA, CCDA, CCNP, CCIE, Checkpoint CCSE, CompTIA A+, Network+ certification practice exams and so on. We guarantee that the candidates will not only pass any IT exam at the first attempt but also get profound understanding about the certificates they have got. There are so many alike companies in this industry, however, ExamBible has its unique advantages that other companies could not achieve.

Our Advances

* 99.9% Uptime

All examinations will be up to date.

* 24/7 Quality Support

We will provide service round the clock.

* 100% Pass Rate

Our guarantee that you will pass the exam.

* Unique Gurantee

If you do not pass the exam at the first time, we will not only arrange FULL REFUND for you, but also provide you another exam of your claim, ABSOLUTELY FREE!

NEW QUESTION 1

- (Exam Topic 1)

HOTSPOT

You are developing the shopping on-the-go project.

You are configuring access to the QnA Maker resources.

Which role should you assign to AllUsers and LeadershipTeam? To answer, select the appropriate options in the answer area.

NOTE: Each correct selection is worth one point.

Answer Area

AllUsers:	<div><div></div><div>Cognitive Service User</div><div>Contributor</div><div>Owner</div><div>QnA Maker Editor</div><div>QnA Maker Read</div></div>
LeadershipTeam:	<div><div></div><div>Cognitive Service User</div><div>Contributor</div><div>Owner</div><div>QnA Maker Editor</div><div>QnA Maker Read</div></div>

A. Mastered

B. Not Mastered

Answer: A

Explanation:

Box 1: QnA Maker Editor

Scenario: Provide all employees with the ability to edit Q&As. The QnA Maker Editor (read/write) has the following permissions: Create KB API

Update KB API Replace KB API Replace Alterations "Train API" [in

new service model v5] Box 2: Contributor

Scenario: Only senior managers must be able to publish updates. Contributor permission: All except ability to add new members to roles

Reference:

<https://docs.microsoft.com/en-us/azure/cognitive-services/qnamaker/reference-role-based-access-control>

NEW QUESTION 2

- (Exam Topic 2)

You are building a chatbot that will provide information to users as shown in the following exhibit.

Passengers

Sarah Hum
Jeremy Goldberg
Evan Litvak

2 Stops

Tue, May 30, 2017 10:25 PM



Non-Stop

Fri, Jun 2, 2017 11:55 PM



Total **\$4,032.54**

Use the drop-down menus to select the answer choice that completes each statement based on the information presented in the graphic.
NOTE: Each correct selection is worth one point.

Answer Area

The chatbot is showing **[answer choice]**.

	▼
an Adaptive Card	
a Hero Card	
a Thumbnail Card	

The card includes **[answer choice]**.

	▼
an action set	
an image	
an image group	
media	

- A. Mastered
- B. Not Mastered

Answer: A

Explanation:

Box 1: A Thumbnail card

A Thumbnail card typically contains a single thumbnail image, some short text, and one or more buttons. Reference:
<https://docs.microsoft.com/en-us/microsoftteams/platform/task-modules-and-cards/cards/cards-reference>

NEW QUESTION 3

- (Exam Topic 2)

Note: This question is part of a series of questions that present the same scenario. Each question in the series contains a unique solution that might meet the stated goals. Some question sets might have more than one correct solution, while others might not have a correct solution.

After you answer a question in this section, you will NOT be able to return to it. As a result, these questions will not appear in the review screen.

You build a language model by using a Language Understanding service. The language model is used to search for information on a contact list by using an intent named FindContact.

A conversational expert provides you with the following list of phrases to use for training. Find contacts in London. Who do I know in Seattle?

Search for contacts in Ukraine.

You need to implement the phrase list in Language Understanding. Solution: You create a new intent for location. Does this meet the goal?

- A. Yes
- B. No

Answer: A

Explanation:

An intent represents a task or action the user wants to perform. It is a purpose or goal expressed in a user's utterance. Define a set of intents that corresponds to actions users want to take in your application. Reference: <https://docs.microsoft.com/en-us/azure/cognitive-services/luis/luis-concept-intent>

NEW QUESTION 4

- (Exam Topic 2)

You are building a chatbot by using the Microsoft Bot Framework Composer. You have the dialog design shown in the following exhibit.

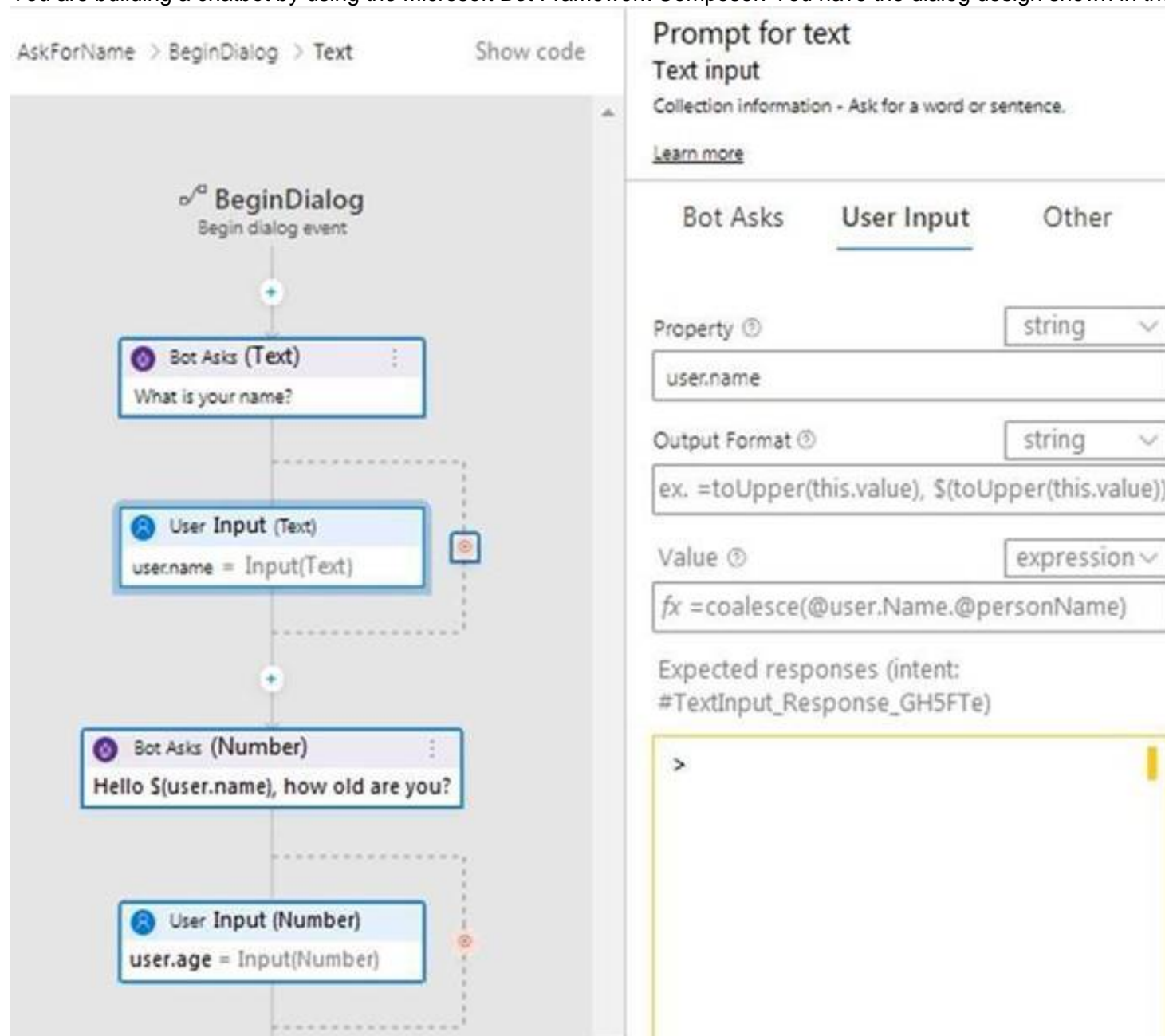

For each of the following statements, select Yes if the statement is true. Otherwise, select No. NOTE: Each correct selection is worth one point.

Answer Area	Statements	Yes	No
	<code>user.name</code> is an entity.	<input type="radio"/>	<input type="radio"/>
	The dialog asks for a user name and a user age and assigns appropriate values to the <code>user.name</code> and <code>user.age</code> properties.	<input type="radio"/>	<input type="radio"/>
	The chatbot attempts to take the first non-null entity value for <code>userName</code> or <code>personName</code> and assigns the value to <code>user.name</code> .	<input type="radio"/>	<input type="radio"/>

- A. Mastered
- B. Not Mastered

Answer: A

Explanation:

Box 1: No
User.name is a property.
Box 2: Yes

Box 3: Yes

The coalesce() function evaluates a list of expressions and returns the first non-null (or non-empty for string) expression.

Reference:

<https://docs.microsoft.com/en-us/composer/concept-language-generation> <https://docs.microsoft.com/en-us/azure/data-explorer/kusto/query/coalescefunction>

NEW QUESTION 5

- (Exam Topic 2)

You have the following C# method for creating Azure Cognitive Services resources programmatically.

```
static void create_resource(CognitiveServicesManagementClient client, string
resource_name, string kind, string account_tier, string location)
{
    CognitiveServicesAccount parameters =
        new CognitiveServicesAccount(null, null, kind, location, resource_name,
new CognitiveServicesAccountProperties(), new Sku(account_tier));
    var result = client.Accounts.Create(resource_group_name, account_tier,
parameters);
}
```

You need to call the method to create a free Azure resource in the West US Azure region. The resource will be used to generate captions of images automatically. Which code should you use?

- A. create_resource(client, "res1", "ComputerVision", "F0", "westus")
- B. create_resource(client, "res1", "CustomVision.Prediction", "F0", "westus")
- C. create_resource(client, "res1", "ComputerVision", "S0", "westus")
- D. create_resource(client, "res1", "CustomVision.Prediction", "S0", "westus")

Answer: B

Explanation:

Many of the Cognitive Services have a free tier you can use to try the service. To use the free tier, use F0 as the SKU for your resource.

There are two tiers of keys for the Custom Vision service. You can sign up for a F0 (free) or S0 (standard) subscription through the Azure portal.

Reference:

<https://docs.microsoft.com/en-us/azure/cognitive-services/cognitive-services-apis-create-account-client-library?> <https://docs.microsoft.com/en-us/azure/cognitive-services/custom-vision-service/limits-and-quotas>

NEW QUESTION 6

- (Exam Topic 2)

You have a web app that uses Azure Cognitive Search.

When reviewing billing for the app, you discover much higher than expected charges. You suspect that the query key is compromised.

You need to prevent unauthorized access to the search endpoint and ensure that users only have read only access to the documents collection. The solution must minimize app downtime.

Which three actions should you perform in sequence? To answer, move the appropriate actions from the list of actions to the answer area and arrange them in the correct order.

Actions	Answer Area
Add a new query key.	
Regenerate the secondary admin key.	
Change the app to use the secondary admin key.	⬅️ ⬆️
Change the app to use the new key.	➡️ ⬇️
Regenerate the primary admin key.	
Delete the compromised key.	

- A. Mastered
- B. Not Mastered

Answer: A

Explanation:

Graphical user interface, text Description automatically generated

Reference:

<https://docs.microsoft.com/en-us/azure/search/search-security-api-keys>

NEW QUESTION 7

- (Exam Topic 2)

You successfully run the following HTTP request. POST

<https://management.azure.com/subscriptions/18c51a87-3a69-47a8-aedc-a54745f708a1/resourceGroups/RG1/pro>

Body{"keyName": "Key2"} What is the result of the request?

- A. A key for Azure Cognitive Services was generated in Azure Key Vault.
- B. A new query key was generated.
- C. The primary subscription key and the secondary subscription key were rotated.
- D. The secondary subscription key was reset.

Answer: B

Explanation:

Accounts - Regenerate Key regenerates the specified account key for the specified Cognitive Services account. Syntax:
POST <https://management.azure.com/subscriptions/{subscriptionId}/resourceGroups/{resourceGroupName}/providers/Microsoft.CognitiveServices/accounts/{accountName}/regenerateKey?api-version=2017-04-18>
Reference:
<https://docs.microsoft.com/en-us/rest/api/cognitiveservices/accountmanagement/accounts/regeneratekey>

NEW QUESTION 8

- (Exam Topic 2)

You are building a language model by using a Language Understanding service. You create a new Language Understanding resource. You need to add more contributors. What should you use?

- A. a conditional access policy in Azure Active Directory (Azure AD)
- B. the Access control (IAM) page for the authoring resources in the Azure portal
- C. the Access control (IAM) page for the prediction resources in the Azure portal

Answer: B

Explanation:

Reference:
<https://docs.microsoft.com/en-us/azure/cognitive-services/luis/luis-how-to-collaborate>

NEW QUESTION 9

- (Exam Topic 2)

You are building a chatbot for a Microsoft Teams channel by using the Microsoft Bot Framework SDK. The chatbot will use the following code.

```
protected override async Task OnMembersAddedAsync(IList<ChannelAccount>
membersAdded, ITurnContext<IConversationUpdateActivity> turnContext,
CancellationTokens cancellationTokens)
{
    foreach (var member in membersAdded)
    {
        if (member.Id != turnContext.Activity.Recipient.Id)
        {
            await turnContext.SendActivityAsync($"Hi there - {member.Name}.
{WelcomeMessage}", cancellationTokens: cancellationTokens);
        }
    }
}
```

For each of the following statements, select Yes if the statement is true. Otherwise, select No.
NOTE: Each correct selection is worth one point.

Answer Area

Statements	Yes	No
OnMembersAddedAsync will be triggered when a user joins the conversation.	<input type="radio"/>	<input type="radio"/>
When a new user joins the conversation, the existing users in the conversation will see the chatbot greeting.	<input type="radio"/>	<input type="radio"/>
OnMembersAddedAsync will be initialized when a user sends a message.	<input type="radio"/>	<input type="radio"/>

- A. Mastered
- B. Not Mastered

Answer: A

Explanation:

Box 1: Yes
The ActivityHandler.OnMembersAddedAsync method overrides this in a derived class to provide logic for when members other than the bot join the conversation, such as your bot's welcome logic.
Box 2: Yes
membersAdded is a list of all the members added to the conversation, as described by the conversation update activity.
Box 3: No
Reference:
<https://docs.microsoft.com/en-us/dotnet/api/microsoft.bot.builder.activityhandler.onmembersaddedasync?view=>

NEW QUESTION 10

- (Exam Topic 2)

Your company wants to reduce how long it takes for employees to log receipts in expense reports. All the receipts are in English. You need to extract top-level information from the receipts, such as the vendor and the transaction total. The solution must minimize development effort. Which Azure Cognitive Services service should you use?

- A. Custom Vision
- B. Personalizer
- C. Form Recognizer
- D. Computer Vision

Answer: C

Explanation:

Azure Form Recognizer is a cognitive service that lets you build automated data processing software using machine learning technology. Identify and extract text, key/value pairs, selection marks, tables, and structure from your documents—the service outputs structured data that includes the relationships in the original file, bounding boxes, confidence and more.

Form Recognizer is composed of custom document processing models, prebuilt models for invoices, receipts, IDs and business cards, and the layout model.

Reference:

<https://docs.microsoft.com/en-us/azure/cognitive-services/form-recognizer>

NEW QUESTION 10

- (Exam Topic 2)

Note: This question is part of a series of questions that present the same scenario. Each question in the series contains a unique solution that might meet the stated goals. Some question sets might have more than one correct solution, while others might not have a correct solution.

After you answer a question in this section, you will NOT be able to return to it. As a result, these questions will not appear in the review screen.

You develop an application to identify species of flowers by training a Custom Vision model. You receive images of new flower species.

You need to add the new images to the classifier.

Solution: You add the new images, and then use the Smart Labeler tool. Does this meet the goal?

- A. Yes
- B. No

Answer: B

Explanation:

The model need to be extended and retrained.

Note: Smart Labeler to generate suggested tags for images. This lets you label a large number of images more quickly when training a Custom Vision model.

NEW QUESTION 14

- (Exam Topic 2)

You have a Video Indexer service that is used to provide a search interface over company videos on your company's website.

You need to be able to search for videos based on who is present in the video. What should you do?

- A. Create a person model and associate the model to the videos.
- B. Create person objects and provide face images for each object.
- C. Invite the entire staff of the company to Video Indexer.
- D. Edit the faces in the videos.
- E. Upload names to a language model.

Answer: A

Explanation:

Video Indexer supports multiple Person models per account. Once a model is created, you can use it by providing the model ID of a specific Person model when uploading/indexing or reindexing a video. Training a new face for a video updates the specific custom model that the video was associated with.

Note: Video Indexer supports face detection and celebrity recognition for video content. The celebrity recognition feature covers about one million faces based on commonly requested data source such as IMDB, Wikipedia, and top LinkedIn influencers. Faces that aren't recognized by the celebrity recognition feature are detected but left unnamed. Once you label a face with a name, the face and name get added to your account's Person model. Video Indexer will then recognize this face in your future videos and past videos.

Reference:

<https://docs.microsoft.com/en-us/azure/media-services/video-indexer/customize-person-model-with-api>

NEW QUESTION 18

- (Exam Topic 2)

You are building a multilingual chatbot.

You need to send a different answer for positive and negative messages.

Which two Text Analytics APIs should you use? Each correct answer presents part of the solution. (Choose two.)

NOTE: Each correct selection is worth one point.

- A. Linked entities from a well-known knowledge base
- B. Sentiment Analysis
- C. Key Phrases
- D. Detect Language
- E. Named Entity Recognition

Answer: BD

Explanation:

B: The Text Analytics API's Sentiment Analysis feature provides two ways for detecting positive and negative sentiment. If you send a Sentiment Analysis request, the API will return sentiment labels (such as "negative", "neutral" and "positive") and confidence scores at the sentence and document-level.

D: The Language Detection feature of the Azure Text Analytics REST API evaluates text input for each document and returns language identifiers with a score that indicates the strength of the analysis.

This capability is useful for content stores that collect arbitrary text, where language is unknown. Reference: <https://docs.microsoft.com/en-us/azure/cognitive-services/text-analytics/how-tos/text-analytics-how-tosentiment-analysis?tabs=version-3-1>

<https://docs.microsoft.com/en-us/azure/cognitive-services/text-analytics/how-tos/text-analytics-how-to-language-detection>

NEW QUESTION 23

- (Exam Topic 2)

You are building a chatbot by using the Microsoft Bot Framework SDK.

You use an object named `UserProfile` to store user profile information and an object named `ConversationData` to store information related to a conversation.

You create the following state accessors to store both objects in state.

```
var userStateAccessors = _userState.CreateProperty<UserProfile>(nameof(UserProfile)); var conversationStateAccessors =
```

```
_conversationState.CreateProperty<ConversationData>(nameof(ConversationData));
```

The state storage mechanism is set to Memory Storage.

For each of the following statements, select Yes if the statement is true. Otherwise, select No.

NOTE: Each correct selection is worth one point.

Answer Area

Statements	Yes	No
The code will create and maintain the <code>UserProfile</code> object in the underlying storage layer.	<input type="radio"/>	<input type="radio"/>
The code will create and maintain the <code>ConversationData</code> object in the underlying storage layer.	<input type="radio"/>	<input type="radio"/>
The <code>UserProfile</code> and <code>ConversationData</code> objects will persist when the Bot Framework runtime terminates.	<input type="radio"/>	<input type="radio"/>

A. Mastered

B. Not Mastered

Answer: A

Explanation:

Box 1: Yes

You create property accessors using the `CreateProperty` method that provides a handle to the `BotState` object. Each state property accessor allows you to get or set the value of the associated state property.

Box 2: Yes

Box 3: No

Before you exit the turn handler, you use the state management objects' `SaveChangesAsync()` method to write all state changes back to storage.

Reference:

<https://docs.microsoft.com/en-us/azure/bot-service/bot-builder-howto-v4-state>

NEW QUESTION 24

- (Exam Topic 2)

You need to build a chatbot that meets the following requirements:

- Supports chit-chat, knowledge base, and multilingual models
- Performs sentiment analysis on user messages
- Selects the best language model automatically

What should you integrate into the chatbot?

A. QnA Maker, Language Understanding, and Dispatch

B. Translator, Speech, and Dispatch

C. Language Understanding, Text Analytics, and QnA Maker

D. Text Analytics, Translator, and Dispatch

Answer: C

Explanation:

Language Understanding: An AI service that allows users to interact with your applications, bots, and IoT devices by using natural language.

QnA Maker is a cloud-based Natural Language Processing (NLP) service that allows you to create a natural conversational layer over your data. It is used to find the most appropriate answer for any input from your custom knowledge base (KB) of information.

Text Analytics: Mine insights in unstructured text using natural language processing (NLP)—no machine learning expertise required. Gain a deeper understanding of customer opinions with sentiment analysis. The Language Detection feature of the Azure Text Analytics REST API evaluates text input

Reference:

<https://azure.microsoft.com/en-us/services/cognitive-services/text-analytics/> <https://docs.microsoft.com/en-us/azure/cognitive-services/qnamaker/overview/overview>

NEW QUESTION 25

- (Exam Topic 2)

You are developing a new sales system that will process the video and text from a public-facing website. You plan to notify users that their data has been processed by the sales system.

Which responsible AI principle does this help meet?

A. transparency

B. fairness

C. inclusiveness

D. reliability and safety

Answer: D

Explanation:

Reference:

<https://docs.microsoft.com/en-us/azure/cloud-adoption-framework/strategy/responsible-ai>

NEW QUESTION 28

- (Exam Topic 2)

A customer uses Azure Cognitive Search.

The customer plans to enable a server-side encryption and use customer-managed keys (CMK) stored in Azure.

What are three implications of the planned change? Each correct answer presents a complete solution.

NOTE: Each correct selection is worth one point.

- A. The index size will increase.
- B. Query times will increase.
- C. A self-signed X.509 certificate is required.
- D. The index size will decrease.
- E. Query times will decrease.
- F. Azure Key Vault is required.

Answer: ABE

Explanation:

Reference:

<https://docs.microsoft.com/en-us/azure/search/search-security-overview>

NEW QUESTION 29

.....

Relate Links

100% Pass Your AI-102 Exam with Examible Prep Materials

<https://www.examible.com/AI-102-exam/>

Contact us

We are proud of our high-quality customer service, which serves you around the clock 24/7.

Viste - <https://www.examible.com/>